

2014



CORBELS, APPLIQUES, ISLAND LEGS

CORBELS, APPLIQUES, SCROLLS & KITCHEN ISLAND LEGS

Pgs. 402-467

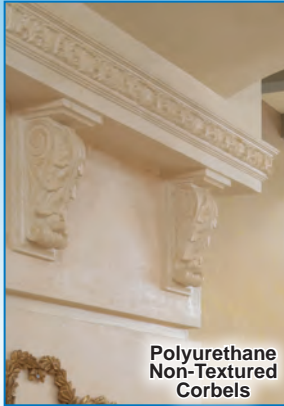

Polyurethane Non-Textured Corbels



Artisan Resin Collection



Polyurethane Non-Textured Ornaments



Kitchen Island Legs



Decorative Resin



Royal Wood Collection



Polyurethane Textured Ornaments

ARTISAN RESIN COLLECTION

Bases.....	432
Capitals.....	432
Cartouches.....	433
Ceiling Elements.....	440
Centers.....	433
Collection Overview.....	402, 431
Columns.....	432
Corbels.....	434
Corner Elements.....	433
Decos.....	435
Drops.....	435
Faces.....	435
Festoons.....	435
Finials.....	435
Friezes.....	436
Keystones.....	439
Kits.....	441-446
Medallions.....	436
Mouldings.....	436
Onlays.....	434
Panels.....	439
Plinth Blocks.....	438
Pulls.....	438
Rings.....	438
Rosettes.....	440
Sconces.....	440
Scrolls.....	437
Specialties.....	437
Swags.....	437

DECORATIVE RESIN

Bases.....	447
Capitals.....	447
Cartouches.....	448
Centers.....	448
Corbels.....	448
Decos.....	449
Festoons.....	449
Rosettes.....	449
Scrolls.....	449
EMBOSSSED VENEER (See EMBOSSSED WOOD)	
Collection Overview.....	402-403
EMBOSSSED WOOD ORNAMENTS	
Appliques.....	450-452
Scrolls.....	452
KITCHEN ISLAND LEGS.....	464-467
POLYMER RESIN ORNAMENTS (See DECORATIVE RESIN)	
Collection Overview.....	402-403
POLYURETHANE NON-TEXTURED CORBELS	
Collection Overview.....	402-403
Corbels.....	462-463
POLYURETHANE NON-TEXTURED ORNAMENTS	
Ceiling Smooth Appliques.....	458-459
Ceiling Smooth Massive Appliques.....	460
Ceiling Smooth Ornaments.....	461
Ceiling Smooth Scrolls.....	459
Collection Overview.....	402-403
Wall Smooth Appliques.....	458-459

SEE PAGES 1007-1023 FOR A - Z INDEX

POLYURETHANE NON-TEXTURED ORNAMENTS

Wall Smooth Massive Appliques.....	460
Wall Smooth Scrolls.....	459

POLYURETHANE TEXTURED ORNAMENTS

Capitals.....	454
Cartouches.....	453
Centers.....	457
Collection Overview.....	402-403
Corbels.....	454
Onlays.....	455-456
Panels.....	456
Rosettes.....	457
Scrolls.....	454

ROYAL WOOD COLLECTION

(North American Hardwood)

Appliques.....	407
Capitals.....	405, 427
Cartouches.....	408-409
Collection Overview.....	402
Corbels & Brackets.....	413-426
Custom Carved Wood Program.....	428
Decos.....	406
Filler Mouldings.....	427
Rosettes.....	404-405, 427
Scrolls.....	410-412

WHITE HARDWOOD

Appliques.....	429-430
Collection Overview.....	402
Corbels.....	430

Decorative Appliques, Corbels & Scrolls

We have expanded our line of decorative appliques, scrolls & corbels. Available in a variety of materials, there is something to fit every design, size and budget. Whether you are putting a finishing touch on a custom cabinet or creating a dramatic focal point on your mantel, we are your source for decorative ornaments.

NOTE: Due to hand carving, slight variations in size and design may occur.

ROYAL WOOD COLLECTION

These ornaments are made of North American Hard Maple, Red Oak, Cherry and Alder.



**All items noted are supplied with pre-attached keyhole hangers.*

Installation:

* These items can be mounted with the pre-attached keyhole brackets. All other items apply a bead of standard construction adhesive to the back of ornament and secure to mounting surface using finish nails or standard screws. Pre-drill and countersink all nails/screws. Fill any holes with wood putty, and sand with a fine grit sandpaper.

Finishing:

Can be painted or faux finished with any quality latex or oil based product. If painting, a prime coat is required. Can be stained with standard stains. Follow stain manufacturer's instructions for top coating. Product varies in color from piece to piece and has a woodgrain texture. Available in maple and white hardwood. See product description for availability.

WHITE HARDWOOD

These ornaments are made of Medium Density light grain White Wood. (Similar to Bass Wood).



Installation:

Apply a bead of standard construction adhesive to the back of ornament and secure to mounting surface using finish nails or standard screws. Pre-drill and countersink all nails/screws. Fill any holes with wood putty, and sand with a fine grit sandpaper.

Finishing:

Can be painted or faux finished with any quality latex or oil based product. If painting, a prime coat is required. Can be stained with standard stains. Follow stain manufacturer's instructions for top coating. See product description for availability.

EMBOSSED VENEER

These ornaments are made of a laminated wood with a veneered surface. Detail is pressed in.



Installation:

Apply a bead of standard construction adhesive to the back of ornament and secure to mounting surface by countersinking finish nails or temporarily secure with a clamp, tape, etc. until adhesive cures. Due to the fragile nature of these items, we recommend pre-drilling any nail holes. Fill any holes with wood putty, and sand with a fine grit sandpaper.

Finishing:

Can be painted or faux finished with any quality latex or oil based product. If painting, a prime coat is required. Can be stained with standard stains. Follow stain manufacturer's instructions for top coating. Product varies in color from piece to piece and has a slight woodgrain texture. Available in Bombax Ceiba (similar to pine), maple and red oak veneer. See product description for availability.

ARTISAN RESIN COLLECTION

Offered in a wide variety of architectural elements crafted from a select Hardwood Maple and Resin blend, The Resin Artisan collection, can be tooled and finished in the same manner as wood.



Installation:

Apply a bead of standard construction adhesive to the back of the ornament and secure it to its intended mounting surface using standard screws (galvanized for exterior applications). Pre-drill and countersink all screws. Fill any holes with exterior wood putty and sand with fine grit sandpaper.

Finishing:

Can either be painted or faux finished with any high quality latex or oil based product. Can also be stained with a gel or non-penetrating stain. Fill any holes with exterior wood putty and sand with fine grit sandpaper.

Some ornaments have been finished for photographic purposes-ornaments come unfinished only.

POLYMER RESIN ORNAMENTS

These ornaments are made of a polymer resin.



Installation:

Apply a bead of standard construction adhesive to the back of ornament, then secure to mounting surface using standard screws (galvanized for exterior applications). Pre-drill and countersink all screws. Fill any holes with exterior wood putty, and sand with a fine grit sandpaper.

Finishing:

Can be painted or faux finished with any quality latex or oil based product. Can also be stained with a gel/non-penetrating stain. Recommended to clean with mineral spirits before finishing. Follow stain manufacturer's instructions for top coating. If painting, priming is not necessary, although two finish coats may be required for light colors. Product is tan in color and surface varies from smooth to woodgrain like texture.

POLYURETHANE

NON-TEXTURED CORBELS

These corbels are made of non-textured high density polyurethane. Lightweight, factory primed and ready to paint.



Installation:

Apply a bead of standard construction adhesive to the back of the ornament and secure it to its intended mounting surface by countersinking finish nails (galvanized for exterior applications) or temporarily secure it with a clamp, tape, or otherwise until the adhesive cures. Fill any holes with exterior wood putty and sand with fine grit sandpaper.

Finishing:

Can be painted or faux finished with any quality latex or oil based product. Can also be stained with a gel/non-penetrating stain. Follow stain manufacturer's instructions for top coating.

POLYURETHANE TEXTURED ORNAMENTS

These ornaments are made of a lightweight polymer.



Installation:

Apply a bead of standard construction adhesive to the back of ornament and secure to mounting surface by countersinking finish nails (galvanized for exterior applications) or temporarily secure with a clamp, tape, etc. until adhesive cures. Fill any holes with exterior wood putty, and sand with a fine grit sandpaper.

Finishing:

Can be painted or faux finished with any quality latex or oil based product. Can also be stained with a gel/non-penetrating stain. Follow stain manufacturer's instructions for top coating. Product is yellowish/beige in color and surface has a simulated woodgrain texture.

POLYURETHANE NON-TEXTURED ORNAMENTS

These ornaments are made of non-textured high density polyurethane. Lightweight, factory primed and ready to paint.



Installation:

Apply a bead of standard construction adhesive to the back of the ornament and secure it to its intended mounting surface by countersinking finish nails (galvanized for exterior applications) or temporarily secure it with a clamp, tape, or otherwise until the adhesive cures. Fill any holes with exterior wood putty and sand with fine grit sandpaper.

Finishing:

Can be painted or faux finished with any quality latex or oil based product. Can also be stained with a gel/non-penetrating stain. Follow stain manufacturer's instructions for top coating.

Some ornaments have been finished for photographic purposes-ornaments come unfinished only.

ROSETTES

These ornaments are made of
North American Hard Maple, Red Oak, Cherry & Alder.



- RWC02-S** (Hard Maple)
- RWC02-S-OAK** (Red Oak)
- RWC02-S-CH** (Cherry)
- RWC02-S-ALD** (Alder)
- 2-7/8" Dia. x 1/2" Depth
- RWC02-M** (Hard Maple)
- RWC02-M-OAK** (Red Oak)
- RWC02-M-CH** (Cherry)
- RWC02-M-ALD** (Alder)
- 3-3/4" Dia. x 5/8" Depth
- RWC02-L** (Hard Maple)
- RWC02-L-OAK** (Red Oak)
- RWC02-L-CH** (Cherry)
- RWC02-L-ALD** (Alder)
- 4-7/8" Dia. x 3/4" Depth
- RWC02-XL** (Hard Maple)
- RWC02-XL-OAK** (Red Oak)
- RWC02-XL-CH** (Cherry)
- RWC02-XL-ALD** (Alder)
- 6-1/2" Dia. x 1" Depth



- RWC003-S** (Hard Maple)
- RWC003-S-OAK** (Red Oak)
- RWC003-S-CH** (Cherry)
- 3-1/2" Dia. x 3/8" Depth
- RWC003-M** (Hard Maple)
- RWC003-M-OAK** (Red Oak)
- RWC003-M-CH** (Cherry)
- 4" Dia. x 1/2" Depth
- RWC003-L** (Hard Maple)
- RWC003-L-OAK** (Red Oak)
- RWC003-L-CH** (Cherry)
- 5-1/2" Dia. x 5/8" Depth
- RWC003-XL** (Hard Maple)
- RWC003-XL-OAK** (Red Oak)
- RWC003-XL-CH** (Cherry)
- 7" Dia. x 7/8" Depth



- RWC004-S** (Hard Maple)
- RWC004-S-OAK** (Red Oak)
- RWC004-S-CH** (Cherry)
- RWC004-S-ALD** (Alder)
- 4" Dia. x 3/8" Depth
- RWC004-M** (Hard Maple)
- RWC004-M-OAK** (Red Oak)
- RWC004-M-CH** (Cherry)
- RWC004-M-ALD** (Alder)
- 5" Dia. x 1/2" Depth
- RWC004-L** (Hard Maple)
- RWC004-L-OAK** (Red Oak)
- RWC004-L-CH** (Cherry)
- RWC004-L-ALD** (Alder)
- 6" Dia. x 5/8" Depth
- RWC004-XL** (Hard Maple)
- RWC004-XL-OAK** (Red Oak)
- RWC004-XL-CH** (Cherry)
- RWC004-XL-ALD** (Alder)
- 8" Dia. x 7/8" Depth



- RWC04-S** (Hard Maple)
- RWC04-S-OAK** (Red Oak)
- RWC04-S-CH** (Cherry)
- RWC04-S-ALD** (Alder)
- 3" Dia. x 1-1/4" Depth
- RWC04-M** (Hard Maple)
- RWC04-M-OAK** (Red Oak)
- RWC04-M-CH** (Cherry)
- RWC04-M-ALD** (Alder)
- 4" Dia. x 1-5/8" Depth
- RWC04-L** (Hard Maple)
- RWC04-L-OAK** (Red Oak)
- RWC04-L-CH** (Cherry)
- RWC04-L-ALD** (Alder)
- 5" Dia. x 2" Depth
- RWC04-XL** (Hard Maple)
- RWC04-XL-OAK** (Red Oak)
- RWC04-XL-CH** (Cherry)
- RWC04-XL-ALD** (Alder)
- 7" Dia. x 2-13/16" Depth



- RWC011-S** (Hard Maple)
- RWC011-S-OAK** (Red Oak)
- RWC011-S-CH** (Cherry)
- RWC011-S-ALD** (Alder)
- 3-1/4"H x 3-1/4" W x 3/8" Depth
- RWC011-M** (Hard Maple)
- RWC011-M-OAK** (Red Oak)
- RWC011-M-CH** (Cherry)
- RWC011-M-ALD** (Alder)
- 4"H x 4" W x 1/2" Depth
- RWC011-L** (Hard Maple)
- RWC011-L-OAK** (Red Oak)
- RWC011-L-CH** (Cherry)
- RWC011-L-ALD** (Alder)
- 4-7/8"H x 4-7/8" W x 5/8" Depth



- RWC01-S** (Hard Maple)
- RWC01-S-OAK** (Red Oak)
- RWC01-S-CH** (Cherry)
- RWC01-S-ALD** (Alder)
- 2-1/2" Sq. x 1/2" Depth
- RWC01-M** (Hard Maple)
- RWC01-M-OAK** (Red Oak)
- RWC01-M-CH** (Cherry)
- RWC01-M-ALD** (Alder)
- 3-1/4" Sq. x 3/4" Depth
- RWC01-L** (Hard Maple)
- RWC01-L-OAK** (Red Oak)
- RWC01-L-CH** (Cherry)
- RWC01-L-ALD** (Alder)
- 3-3/4" Sq. x 7/8" Depth

(Measurements are approximate)

ROSETTES & CAPITALS

These ornaments are made of North American Hard Maple, Red Oak, Cherry & Alder.



- RWC008-S** (Hard Maple)
- RWC008-S-OAK** (Red Oak)
- RWC008-S-CH** (Cherry)
- 3-1/4" H x 1-5/8" W x 3/8" Depth
- RWC008-M** (Hard Maple)
- RWC008-M-OAK** (Red Oak)
- RWC008-M-CH** (Cherry)
- 3-7/8" H x 1-7/8" W x 1/2" Depth
- RWC008-L** (Hard Maple)
- RWC008-L-OAK** (Red Oak)
- RWC008-L-CH** (Cherry)
- 5-3/8" H x 2-1/2" W x 1/2" Depth
- RWC008-XL** (Hard Maple)
- RWC008-XL-OAK** (Red Oak)
- RWC008-XL-CH** (Cherry)
- 5-7/8" H x 3-1/4" W x 5/8" Depth



- RWC104-XS** (Hard Maple)
- RWC104-XS-OAK** (Red Oak)
- RWC104-XS-CH** (Cherry)
- 3" H x 3" W x 3/8" Depth
- RWC104-S** (Hard Maple)
- RWC104-S-OAK** (Red Oak)
- RWC104-S-CH** (Cherry)
- 4" H x 4" W x 1/2" Depth
- RWC104-M** (Hard Maple)
- RWC104-M-OAK** (Red Oak)
- RWC104-M-CH** (Cherry)
- 5" H x 5" W x 1/2" Depth
- RWC104-L** (Hard Maple)
- RWC104-L-OAK** (Red Oak)
- RWC104-L-CH** (Cherry)
- 6" H x 6" W x 5/8" Depth
- RWC104-XL** (Hard Maple)
- RWC104-XL-OAK** (Red Oak)
- RWC104-XL-CH** (Cherry)
- 8" H x 8" W x 7/8" Depth



- RWC009-S** (Hard Maple)
- RWC009-S-OAK** (Red Oak)
- RWC009-S-CH** (Cherry)
- RWC009-S-ALD** (Alder)
- 3-1/8" H x 3" W x 1/2" Depth
- RWC009-L** (Hard Maple)
- RWC009-L-OAK** (Red Oak)
- RWC009-L-CH** (Cherry)
- RWC009-L-ALD** (Alder)
- 3-7/8" H x 3-3/4" W x 5/8" Depth



- RWC113-S** (Hard Maple)
- RWC113-S-OAK** (Red Oak)
- RWC113-S-CH** (Cherry)
- RWC113-S-ALD** (Alder)
- 5-1/2" H x 3-1/4" W x 1" Depth
- 2-3/4" Collar***
- RWC113-L** (Hard Maple)
- RWC113-L-OAK** (Red Oak)
- RWC113-L-CH** (Cherry)
- RWC113-L-ALD** (Alder)
- 7-1/2" H x 4-1/2" W x 1-1/4" Depth
- 3-3/4" Collar***



- RWC116-S** (Hard Maple)
- RWC116-S-OAK** (Red Oak)
- RWC116-S-CH** (Cherry)
- 3" H x 6-7/8" W x 1-5/8" Depth
- 2-3/4" Collar***
- RWC116-M** (Hard Maple)
- RWC116-M-OAK** (Red Oak)
- RWC116-M-CH** (Cherry)
- 4" H x 9-1/4" W x 2" Depth
- 3-3/4" Collar***
- RWC116-L** (Hard Maple)
- RWC116-L-OAK** (Red Oak)
- RWC116-L-CH** (Cherry)
- 4-5/8" H x 10-3/8" W x 2-3/8" Depth



- RWC119-S** (Hard Maple)
- RWC119-S-OAK** (Red Oak)
- RWC119-S-CH** (Cherry)
- RWC119-S-ALD** (Alder)
- 4" H x 3-7/8" W x 1" Depth
- 2-3/4" Collar***
- RWC119-M** (Hard Maple)
- RWC119-M-OAK** (Red Oak)
- RWC119-M-CH** (Cherry)
- RWC119-M-ALD** (Alder)
- 5-3/8" H x 5-1/4" W x 1-1/8" Depth
- 3-3/4" Collar***
- RWC119-L** (Hard Maple)
- RWC119-L-OAK** (Red Oak)
- RWC119-L-CH** (Cherry)
- RWC119-L-ALD** (Alder)
- 6-1/4" H x 6-1/8" W x 1-1/4" Depth
- RWC119-XL** (Hard Maple)
- RWC119-XL-OAK** (Red Oak)
- RWC119-XL-CH** (Cherry)
- RWC119-XL-ALD** (Alder)
- 8-1/8" H x 8-1/8" W x 1-5/8" Depth



- RWC122-S** (Hard Maple)
- RWC122-S-OAK** (Red Oak)
- RWC122-S-CH** (Cherry)
- 3-3/8" H x 4-1/8" W x 1-3/8" Depth
- 2-3/4" Collar***
- RWC122-L** (Hard Maple)
- RWC122-L-OAK** (Red Oak)
- RWC122-L-CH** (Cherry)
- 4-3/4" H x 5-5/8" W x 1-3/4" Depth
- 3-3/4" Collar***

***See coordinating filler mouldings on page 427.**

(Measurements are approximate)

DECOS

These ornaments are made of
North American Hard Maple, Red Oak, Cherry & Alder.



- RWC007-S** (Hard Maple)
- RWC007-S-OAK** (Red Oak)
- RWC007-S-CH** (Cherry)
- RWC007-S-ALD** (Alder)
- 5-5/8" H x 3-1/4" W x 3/4" Depth
- RWC007-M** (Hard Maple)
- RWC007-M-OAK** (Red Oak)
- RWC007-M-CH** (Cherry)
- RWC007-M-ALD** (Alder)
- 7-5/8" H x 4-3/8" W x 1" Depth
- RWC007-L** (Hard Maple)
- RWC007-L-OAK** (Red Oak)
- RWC007-L-CH** (Cherry)
- RWC007-L-ALD** (Alder)
- 9-1/8" H x 5-1/4" W x 1-1/8" Depth
- RWC007-XL** (Hard Maple)
- RWC007-XL-OAK** (Red Oak)
- RWC007-XL-CH** (Cherry)
- RWC007-XL-ALD** (Alder)
- 11-7/8" H x 7" W x 1-3/8" Depth



- RWC05-S** (Hard Maple)
- RWC05-S-OAK** (Red Oak)
- RWC05-S-CH** (Cherry)
- RWC05-S-ALD** (Alder)
- 5-7/8" H x 2-1/2" W x 7/8" Depth
- RWC05-M** (Hard Maple)
- RWC05-M-OAK** (Red Oak)
- RWC05-M-CH** (Cherry)
- RWC05-M-ALD** (Alder)
- 7-1/2" H x 3-1/8" W x 1" Depth
- RWC05-L** (Hard Maple)
- RWC05-L-OAK** (Red Oak)
- RWC05-L-CH** (Cherry)
- RWC05-L-ALD** (Alder)
- 9-1/4" H x 3-7/8" W x 1-1/4" Depth



- RWC101-S** (Hard Maple)
- RWC101-S-OAK** (Red Oak)
- RWC101-S-CH** (Cherry)
- 5-5/8" H x 3-3/8" W x 3/4" Depth
- RWC101-M** (Hard Maple)
- RWC101-M-OAK** (Red Oak)
- RWC101-M-CH** (Cherry)
- 7-1/2" H x 4-1/2" W x 1" Depth
- RWC101-L** (Hard Maple)
- RWC101-L-OAK** (Red Oak)
- RWC101-L-CH** (Cherry)
- 9-1/8" H x 5-1/2" W x 1-1/8" Depth
- RWC101-XL** (Hard Maple)
- RWC101-XL-OAK** (Red Oak)
- RWC101-XL-CH** (Cherry)
- 12" H x 7" W x 1-3/8" Depth



- RWC010-S** (Hard Maple)
- RWC010-S-OAK** (Red Oak)
- RWC010-S-CH** (Cherry)
- 2-7/8" H x 1-1/8" W x 3/8" Depth
- RWC010-M** (Hard Maple)
- RWC010-M-OAK** (Red Oak)
- RWC010-M-CH** (Cherry)
- 3-7/8" H x 1-1/2" W x 1/2" Depth
- RWC010-L** (Hard Maple)
- RWC010-L-OAK** (Red Oak)
- RWC010-L-CH** (Cherry)
- 5" H x 1-7/8" W x 1/2" Depth



- RWC006-S** (Hard Maple)
- RWC006-S-OAK** (Red Oak)
- RWC006-S-CH** (Cherry)
- 3-3/8" H x 2-7/8" W x 5/8" Depth
- RWC006-M** (Hard Maple)
- RWC006-M-OAK** (Red Oak)
- RWC006-M-CH** (Cherry)
- 3-7/8" H x 3-3/8" W x 3/4" Depth
- RWC006-L** (Hard Maple)
- RWC006-L-OAK** (Red Oak)
- RWC006-L-CH** (Cherry)
- 5-3/8" H x 4-1/2" W x 1" Depth



- RWC005-S** (Hard Maple)
- RWC005-S-OAK** (Red Oak)
- RWC005-S-CH** (Cherry)
- RWC005-S-ALD** (Alder)
- 3-1/4" H x 2" W x 1/2" Depth
- RWC005-M** (Hard Maple)
- RWC005-M-OAK** (Red Oak)
- RWC005-M-CH** (Cherry)
- RWC005-M-ALD** (Alder)
- 5" H x 3" W x 5/8" Depth
- RWC005-L** (Hard Maple)
- RWC005-L-OAK** (Red Oak)
- RWC005-L-CH** (Cherry)
- RWC005-L-ALD** (Alder)
- 6-5/8" H x 3-7/8" W x 7/8" Depth

(Measurements are approximate)

APPLIQUES

These ornaments are made of North American Hard Maple, Red Oak, Cherry & Alder.



RWC107-M (Hard Maple)
RWC107-M-OAK (Red Oak)
RWC107-M-CH (Cherry)
RWC107-M-ALD (Alder)
 9-7/8" H x 5-1/4" W x 5/8" Depth



••••• **RWC131-S** (Hard Maple)
RWC131-S-OAK (Red Oak)
RWC131-S-CH (Cherry)
RWC131-S-ALD (Alder)
 12" H x 1-1/2" W x 3/8" Depth
RWC131-L (Hard Maple)
RWC131-L-OAK (Red Oak)
RWC131-L-CH (Cherry)
RWC131-L-ALD (Alder)
 17-1/4" H x 2" W x 3/8" Depth

**Supplied with pre-attached keyhole hangers.*

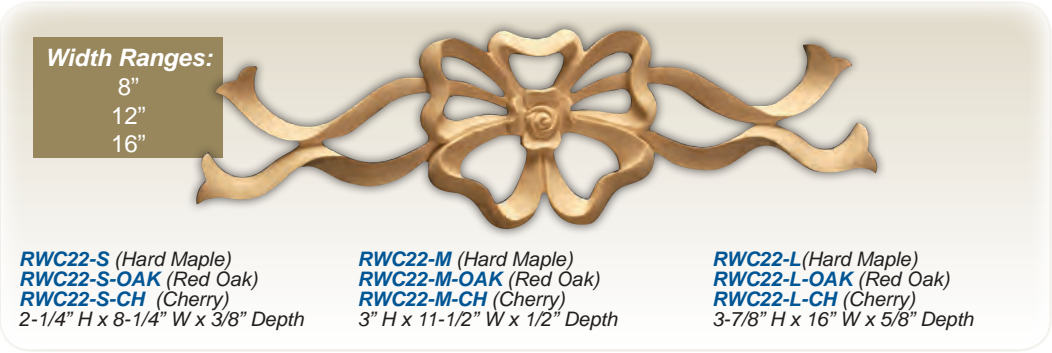

Width Ranges:
 8"
 12"
 16"

RWC22-S (Hard Maple)
RWC22-S-OAK (Red Oak)
RWC22-S-CH (Cherry)
 2-1/4" H x 8-1/4" W x 3/8" Depth

RWC22-M (Hard Maple)
RWC22-M-OAK (Red Oak)
RWC22-M-CH (Cherry)
 3" H x 11-1/2" W x 1/2" Depth

RWC22-L (Hard Maple)
RWC22-L-OAK (Red Oak)
RWC22-L-CH (Cherry)
 3-7/8" H x 16" W x 5/8" Depth

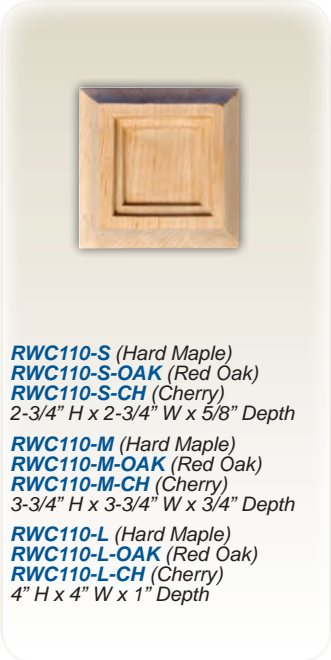

RWC110-S (Hard Maple)
RWC110-S-OAK (Red Oak)
RWC110-S-CH (Cherry)
 2-3/4" H x 2-3/4" W x 5/8" Depth

RWC110-M (Hard Maple)
RWC110-M-OAK (Red Oak)
RWC110-M-CH (Cherry)
 3-3/4" H x 3-3/4" W x 3/4" Depth

RWC110-L (Hard Maple)
RWC110-L-OAK (Red Oak)
RWC110-L-CH (Cherry)
 4" H x 4" W x 1" Depth

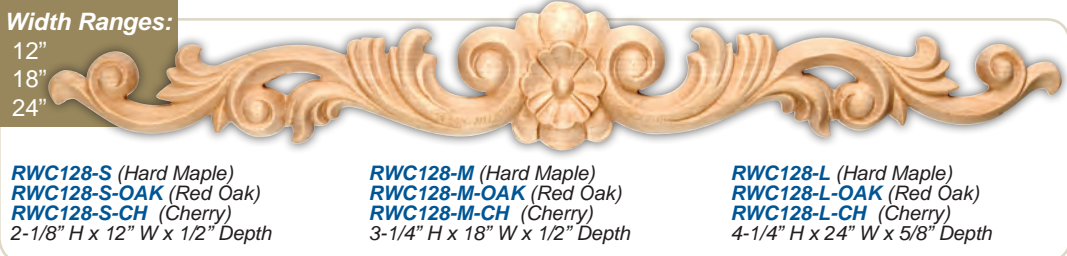

Width Ranges:
 12"
 18"
 24"

RWC128-S (Hard Maple)
RWC128-S-OAK (Red Oak)
RWC128-S-CH (Cherry)
 2-1/8" H x 12" W x 1/2" Depth

RWC128-M (Hard Maple)
RWC128-M-OAK (Red Oak)
RWC128-M-CH (Cherry)
 3-1/4" H x 18" W x 1/2" Depth

RWC128-L (Hard Maple)
RWC128-L-OAK (Red Oak)
RWC128-L-CH (Cherry)
 4-1/4" H x 24" W x 5/8" Depth

(Measurements are approximate)

CARTOUCHES

These ornaments are made of North American Hard Maple, Red Oak, Cherry & Alder.

Width Ranges:

- 18"
- 24"
- 31"



RWC17-S (Hard Maple)
RWC17-S-OAK (Red Oak)
RWC17-S-CH (Cherry)
 3-3/8" H x 18-1/4" W x 1/2" Depth

RWC17-M (Hard Maple)
RWC17-M-OAK (Red Oak)
RWC17-M-CH (Cherry)
 4-3/8" H x 23-7/8" W x 1/2" Depth

RWC17-L (Hard Maple)
RWC17-L-OAK (Red Oak)
RWC17-L-CH (Cherry)
 5-3/4" H x 31" W x 5/8" Depth

Width Ranges:

- 12"
- 18"
- 28"



RWC24-S (Hard Maple)
RWC24-S-OAK (Red Oak)
RWC24-S-CH (Cherry)
RWC24-S-ALD (Alder)
 2-1/2" H x 12" W x 3/8" Depth

RWC24-M (Hard Maple)
RWC24-M-OAK (Red Oak)
RWC24-M-CH (Cherry)
RWC24-M-ALD (Alder)
 3-3/4" H x 18-3/8" W x 1/2" Depth

RWC24-L (Hard Maple)
RWC24-L-OAK (Red Oak)
RWC24-L-CH (Cherry)
RWC24-L-ALD (Alder)
 5-5/8" H x 27-1/2" W x 5/8" Depth

Width Ranges:

- 12"
- 18"
- 24"
- 30"



RWC19-S (Hard Maple)
RWC19-S-OAK (Red Oak)
RWC19-S-CH (Cherry)
RWC19-S-ALD (Alder)
 2-5/8" H x 12" W x 3/8" Depth

RWC19-M (Hard Maple)
RWC19-M-OAK (Red Oak)
RWC19-M-CH (Cherry)
RWC19-M-ALD (Alder)
 3-7/8" H x 18-1/4" W x 1/2" Depth

RWC19-L (Hard Maple)
RWC19-L-OAK (Red Oak)
RWC19-L-CH (Cherry)
RWC19-L-ALD (Alder)
 5-1/4" H x 24" W x 5/8" Depth

RWC19-XL (Hard Maple)
RWC19-XL-OAK (Red Oak)
RWC19-XL-CH (Cherry)
RWC19-XL-ALD (Alder)
 6-1/2" H x 30" W x 3/4" Depth

Width Ranges:

- 9"
- 12"
- 16"
- 20"



RWC18-S (Hard Maple)
RWC18-S-OAK (Red Oak)
RWC18-S-CH (Cherry)
 2-1/2" H x 9" W x 3/8" Depth

RWC18-M (Hard Maple)
RWC18-M-OAK (Red Oak)
RWC18-M-CH (Cherry)
 3-1/2" H x 11-7/8" W x 1/2" Depth

RWC18-L (Hard Maple)
RWC18-L-OAK (Red Oak)
RWC18-L-CH (Cherry)
 4-1/2" H x 15-7/8" W x 1/2" Depth

RWC18-XL (Hard Maple)
RWC18-XL-OAK (Red Oak)
RWC18-XL-CH (Cherry)
 5-7/8" H x 20-1/8" W x 5/8" Depth

Width Ranges:

- 6"
- 11"
- 16"

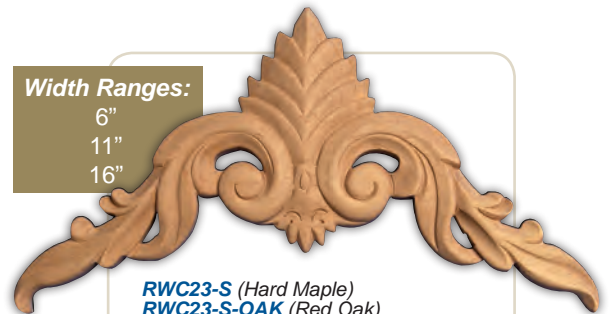

RWC23-S (Hard Maple)
RWC23-S-OAK (Red Oak)
RWC23-S-CH (Cherry)
RWC23-S-ALD (Alder)
 2-3/4" H x 5-1/2" W x 3/8" Depth

RWC23-M (Hard Maple)
RWC23-M-OAK (Red Oak)
RWC23-M-CH (Cherry)
RWC23-M-ALD (Alder)
 5-1/2" H x 10-7/8" W x 1/2" Depth

RWC23-L (Hard Maple)
RWC23-L-OAK (Red Oak)
RWC23-L-CH (Cherry)
RWC23-L-ALD (Alder)
 8-1/8" H x 15-7/8" W x 5/8" Depth

(Measurements are approximate)

CARTOUCHES

These ornaments are made of North American Hard Maple, Red Oak, Cherry & Alder.



Width Ranges:

- 18"
- 24"
- 30"



RWC125-S (Hard Maple)
RWC125-S-OAK (Red Oak)
RWC125-S-CH (Cherry)
 3-5/8" H x 18" W x 3/4" Depth

RWC125-M (Hard Maple)
RWC125-M-OAK (Red Oak)
RWC125-M-CH (Cherry)
 4-3/4" H x 24" W x 7/8" Depth

RWC125-L (Hard Maple)
RWC125-L-OAK (Red Oak)
RWC125-L-CH (Cherry)
 6" H x 30" W x 1" Depth

Width Ranges:

- 22"
- 31"



***RWC92-S** (Hard Maple)
***RWC92-S-OAK** (Red Oak)
***RWC92-S-CH** (Cherry)
 6-3/4" H x 21-1/2" W x 1-3/4" Depth

***RWC92-L** (Hard Maple)
***RWC92-L-OAK** (Red Oak)
***RWC92-L-CH** (Cherry)
 9-7/8" H x 30-3/4" W x 2-1/2" Depth

***Supplied with pre-attached keyhole hangers.**



shown painted

Width Ranges:

- 12"
- 18"
- 24"
- 36"



RWC20-S (Hard Maple)
RWC20-S-OAK (Red Oak)
RWC20-S-CH (Cherry)
 2-1/2" H x 12" W x 3/8" Depth

RWC20-M (Hard Maple)
RWC20-M-OAK (Red Oak)
RWC20-M-CH (Cherry)
 3-3/4" H x 18-1/8" W x 1/2" Depth

RWC20-L (Hard Maple)
RWC20-L-OAK (Red Oak)
RWC20-L-CH (Cherry)
 5" H x 24" W x 5/8" Depth

RWC20-XL (Hard Maple)
RWC20-XL-OAK (Red Oak)
RWC20-XL-CH (Cherry)
 7-3/8" H x 36" W x 3/4" Depth

Width Ranges:

- 16"
- 24"



RWC25-S (Hard Maple)
RWC25-S-OAK (Red Oak)
RWC25-S-CH (Cherry)
RWC25-S-ALD (Alder)
 3-7/8" H x 16-1/8" W x 1/2" Depth

RWC25-L (Hard Maple)
RWC25-L-OAK (Red Oak)
RWC25-L-CH (Cherry)
RWC25-L-ALD (Alder)
 5-1/4" H x 24-3/8" W x 5/8" Depth

(Measurements are approximate)

SCROLLS

SOLD AS A LEFT & RIGHT PAIR
(dimensions are for one side only)

These ornaments are made of
North American Hard Maple, Red Oak, Cherry & Alder.



RWC32-S (Hard Maple)
RWC32-S-OAK (Red Oak)
RWC32-S-CH (Cherry)
RWC32-S-ALD (Alder)
4-3/4" H x 9" W x 3/8" Depth

RWC32-M (Hard Maple)
RWC32-M-OAK (Red Oak)
RWC32-M-CH (Cherry)
RWC32-M-ALD (Alder)
5-7/8" H x 11-1/4" W x 1/2" Depth

RWC32-L (Hard Maple)
RWC32-L-OAK (Red Oak)
RWC32-L-CH (Cherry)
RWC32-L-ALD (Alder)
7-1/4" H x 14" W x 5/8" Depth



RWC201-S (Hard Maple)
RWC201-S-OAK (Red Oak)
RWC201-S-CH (Cherry)
RWC201-S-ALD (Alder)
5" H x 3-3/4" W x 1/2" Depth

RWC201-M (Hard Maple)
RWC201-M-OAK (Red Oak)
RWC201-M-CH (Cherry)
RWC201-M-ALD (Alder)
9" H x 6-3/4" W x 1/2" Depth

RWC201-L (Hard Maple)
RWC201-L-OAK (Red Oak)
RWC201-L-CH (Cherry)
RWC201-L-ALD (Alder)
12" H x 9-1/8" W x 5/8" Depth



RWC33-S (Hard Maple)
RWC33-S-OAK (Red Oak)
RWC33-S-CH (Cherry)
2" H x 5" W x 3/8" Depth

RWC33-M (Hard Maple)
RWC33-M-OAK (Red Oak)
RWC33-M-CH (Cherry)
2-3/4" H x 7" W x 1/2" Depth

RWC33-L (Hard Maple)
RWC33-L-OAK (Red Oak)
RWC33-L-CH (Cherry)
4-3/4" H x 12" W x 1/2" Depth

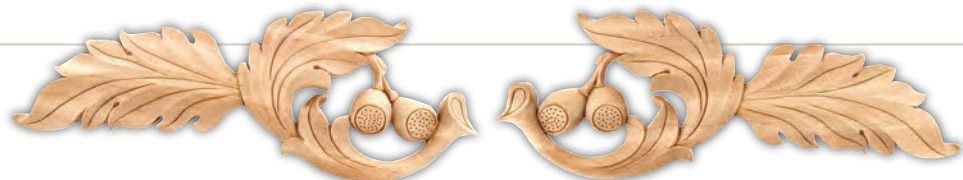

RWC30-S (Hard Maple)
RWC30-S-OAK (Red Oak)
RWC30-S-CH (Cherry)
2-1/8" H x 6" W x 3/8" Depth

RWC30-M (Hard Maple)
RWC30-M-OAK (Red Oak)
RWC30-M-CH (Cherry)
2-7/8" H x 7-7/8" W x 1/2" Depth

RWC30-L (Hard Maple)
RWC30-L-OAK (Red Oak)
RWC30-L-CH (Cherry)
5" H x 13-3/4" W x 5/8" Depth

(Measurements are approximate)

SCROLLS

SOLD AS A LEFT & RIGHT PAIR
(dimensions are for one side only)

These ornaments are made of
North American Hard Maple, Red Oak, Cherry & Alder.

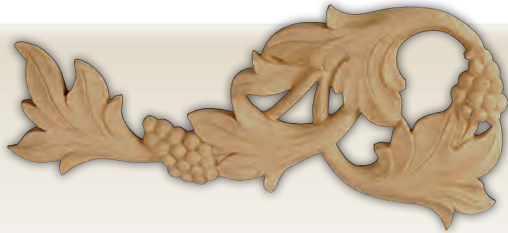

RWC27-S (Hard Maple)
RWC27-S-OAK (Red Oak)
RWC27-S-CH (Cherry)
2-3/4" H x 6" W x 3/8" Depth

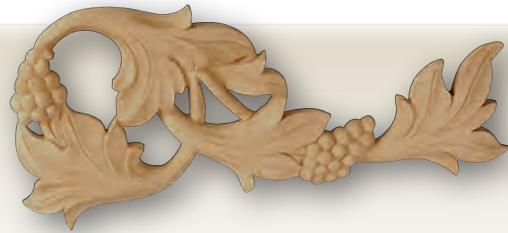

RWC27-M (Hard Maple)
RWC27-M-OAK (Red Oak)
RWC27-M-CH (Cherry)
4-1/8" H x 9" W x 1/2" Depth

RWC27-L (Hard Maple)
RWC27-L-OAK (Red Oak)
RWC27-L-CH (Cherry)
5-5/8" H x 11-7/8" W x 5/8" Depth

RWC27-XL (Hard Maple)
RWC27-XL-OAK (Red Oak)
RWC27-XL-CH (Cherry)
7-1/8" H x 15" W x 3/4" Depth



***RWC28** (Hard Maple)
***RWC28-OAK** (Red Oak)
***RWC28-CH** (Cherry)
7" H x 6-1/8" W x 1-1/8" Depth

***Supplied with pre-attached
keyhole hangers.**



RWC29-S (Hard Maple)
RWC29-S-OAK (Red Oak)
RWC29-S-CH (Cherry)
RWC29-S-ALD (Alder)
4" H x 3-5/8" W x 1/2" Depth



RWC29-M (Hard Maple)
RWC29-M-OAK (Red Oak)
RWC29-M-CH (Cherry)
RWC29-M-ALD (Alder)
5-3/8" H x 4-7/8" W x 5/8" Depth

RWC29-L (Hard Maple)
RWC29-L-OAK (Red Oak)
RWC29-L-CH (Cherry)
RWC29-L-ALD (Alder)
7-1/2" H x 6-7/8" W x 3/4" D

RWC29-XL (Hard Maple)
RWC29-XL-OAK (Red Oak)
RWC29-XL-CH (Cherry)
RWC29-XL-ALD (Alder)
10-3/4" H x 9-5/8" W x 7/8" D

(Measurements are approximate)

SCROLLS

SOLD AS A LEFT & RIGHT PAIR
(dimensions are for one side only)

These ornaments are made of
North American Hard Maple, Red Oak, Cherry & Alder.



- RWC91-S** (Hard Maple)
- RWC91-S-OAK** (Red Oak)
- RWC91-S-CH** (Cherry)
- 11-3/8" H x 4-3/8" W x 1/2" Depth
- RWC91-M** (Hard Maple)
- RWC91-M-OAK** (Red Oak)
- RWC91-M-CH** (Cherry)
- 15-5/8" H x 6" W x 5/8" Depth
- RWC91-L** (Hard Maple)
- RWC91-L-OAK** (Red Oak)
- RWC91-L-CH** (Cherry)
- 20-3/8" H x 7-7/8" W x 1" Depth



- RWC26-S** (Hard Maple)
- RWC26-S-OAK** (Red Oak)
- RWC26-S-CH** (Cherry)
- 2-3/8" H x 6" W x 3/8" Depth
- RWC26-M** (Hard Maple)
- RWC26-M-OAK** (Red Oak)
- RWC26-M-CH** (Cherry)
- 3-1/2" H x 9" W x 1/2" Depth
- RWC26-L** (Hard Maple)
- RWC26-L-OAK** (Red Oak)
- RWC26-L-CH** (Cherry)
- 4-3/4" H x 11-7/8" W x 5/8" Depth
- RWC26-XL** (Hard Maple)
- RWC26-XL-OAK** (Red Oak)
- RWC26-XL-CH** (Cherry)
- 6-3/8" H x 15" W x 3/4" Depth



- RWC204-S** (Hard Maple)
- RWC204-S-OAK** (Red Oak)
- RWC204-S-CH** (Cherry)
- RWC204-S-ALD** (Alder)
- 2-1/2" H x 5-1/2" W x 3/8" Depth
- RWC204-M** (Hard Maple)
- RWC204-M-OAK** (Red Oak)
- RWC204-M-CH** (Cherry)
- RWC204-M-ALD** (Alder)
- 3-7/8" H x 9-1/8" W x 1/2" Depth
- RWC204-L** (Hard Maple)
- RWC204-L-OAK** (Red Oak)
- RWC204-L-CH** (Cherry)
- RWC204-L-ALD** (Alder)
- 5-1/4" H x 12" W x 1/2" Depth

(Measurements are approximate)

PLAIN CORBELS & BRACKETS

These ornaments are made of North American Hard Maple, Red Oak, Cherry, & Alder.



RWC900-S (Hard Maple)
RWC900-S-OAK (Red Oak)
RWC900-S-CH (Cherry)
RWC900-S-ALD (Alder)
 10" H x 1-7/8" W x 7" Depth

RWC900-M (Hard Maple)
RWC900-M-OAK (Red Oak)
RWC900-M-CH (Cherry)
RWC900-M-ALD (Alder)
 12" H x 2-1/2" W x 8" Depth

RWC900-L (Hard Maple)
RWC900-L-OAK (Red Oak)
RWC900-L-CH (Cherry)
RWC900-L-ALD (Alder)
 14" H x 3" W x 9" Depth



RWC905-S (Hard Maple)
RWC905-S-OAK (Red Oak)
RWC905-S-CH (Cherry)
RWC905-S-ALD (Alder)
 10" H x 1-7/8" W x 7" Depth

RWC905-M (Hard Maple)
RWC905-M-OAK (Red Oak)
RWC905-M-CH (Cherry)
RWC905-M-ALD (Alder)
 12" H x 2-1/2" W x 8" Depth

RWC905-L (Hard Maple)
RWC905-L-OAK (Red Oak)
RWC905-L-CH (Cherry)
RWC905-L-ALD (Alder)
 14" H x 3" W x 9" Depth



RWC910-S (Hard Maple)
RWC910-S-OAK (Red Oak)
RWC910-S-CH (Cherry)
RWC910-S-ALD (Alder)
 10" H x 1-7/8" W x 7" Depth

RWC910-M (Hard Maple)
RWC910-M-OAK (Red Oak)
RWC910-M-CH (Cherry)
RWC910-M-ALD (Alder)
 12" H x 2-1/2" W x 8" Depth

RWC910-L (Hard Maple)
RWC910-L-OAK (Red Oak)
RWC910-L-CH (Cherry)
RWC910-L-ALD (Alder)
 14" H x 3" W x 9" Depth

***Supplied with pre-attached keyhole hangers.**



RWC915-S (Hard Maple)
RWC915-S-OAK (Red Oak)
RWC915-S-CH (Cherry)
RWC915-S-ALD (Alder)
 10" H x 1-7/8" W x 7" Depth

RWC915-M (Hard Maple)
RWC915-M-OAK (Red Oak)
RWC915-M-CH (Cherry)
RWC915-M-ALD (Alder)
 12" H x 2-1/2" W x 8" Depth

RWC915-L (Hard Maple)
RWC915-L-OAK (Red Oak)
RWC915-L-CH (Cherry)
RWC915-L-ALD (Alder)
 14" H x 3" W x 9" Depth



RWC920-S (Hard Maple)
RWC920-S-OAK (Red Oak)
RWC920-S-CH (Cherry)
RWC920-S-ALD (Alder)
 10" H x 2-1/8" W x 7" Depth

RWC920-M (Hard Maple)
RWC920-M-OAK (Red Oak)
RWC920-M-CH (Cherry)
RWC920-M-ALD (Alder)
 12" H x 2-1/2" W x 8" Depth

RWC920-L (Hard Maple)
RWC920-L-OAK (Red Oak)
RWC920-L-CH (Cherry)
RWC920-L-ALD (Alder)
 14" H x 3-1/4" W x 9" Depth



(Measurements are approximate)

PLAIN CORBELS & BRACKETS

These ornaments are made of North American Hard Maple, Red Oak, Cherry, & Alder.



- RWC925-S** (Hard Maple)
- RWC925-S-OAK** (Red Oak)
- RWC925-S-CH** (Cherry)
- RWC925-S-ALD** (Alder)
- 10" H x 2-1/2" W x 7" Depth
- RWC925-M** (Hard Maple)
- RWC925-M-OAK** (Red Oak)
- RWC925-M-CH** (Cherry)
- RWC925-M-ALD** (Alder)
- 12" H x 3" W x 8" Depth
- RWC925-L** (Hard Maple)
- RWC925-L-OAK** (Red Oak)
- RWC925-L-CH** (Cherry)
- RWC925-L-ALD** (Alder)
- 14" H x 3-7/8" W x 9" Depth



- RWC930-S** (Hard Maple)
- RWC930-S-OAK** (Red Oak)
- RWC930-S-CH** (Cherry)
- RWC930-S-ALD** (Alder)
- 10" H x 2-1/2" W x 7" Depth
- RWC930-M** (Hard Maple)
- RWC930-M-OAK** (Red Oak)
- RWC930-M-CH** (Cherry)
- RWC930-M-ALD** (Alder)
- 12" H x 3" W x 8" Depth
- RWC930-L** (Hard Maple)
- RWC930-L-OAK** (Red Oak)
- RWC930-L-CH** (Cherry)
- RWC930-L-ALD** (Alder)
- 14" H x 3-5/8" W x 9" Depth

**Supplied with pre-attached keyhole hangers.*



- RWC935-S** (Hard Maple)
- RWC935-S-OAK** (Red Oak)
- RWC935-S-CH** (Cherry)
- RWC935-S-ALD** (Alder)
- 10" H x 2-3/8" W x 7" Depth
- RWC935-M** (Hard Maple)
- RWC935-M-OAK** (Red Oak)
- RWC935-M-CH** (Cherry)
- RWC935-M-ALD** (Alder)
- 12" H x 2-5/8" W x 8" Depth
- RWC935-L** (Hard Maple)
- RWC935-L-OAK** (Red Oak)
- RWC935-L-CH** (Cherry)
- RWC935-L-ALD** (Alder)
- 14" H x 3-1/4" W x 9" Depth



- RWC940-S** (Hard Maple)
- RWC940-S-OAK** (Red Oak)
- RWC940-S-CH** (Cherry)
- RWC940-S-ALD** (Alder)
- 10" H x 1-7/8" W x 7" Depth
- RWC940-M** (Hard Maple)
- RWC940-M-OAK** (Red Oak)
- RWC940-M-CH** (Cherry)
- RWC940-M-ALD** (Alder)
- 12" H x 2-1/2" W x 8" Depth
- RWC940-L** (Hard Maple)
- RWC940-L-OAK** (Red Oak)
- RWC940-L-CH** (Cherry)
- RWC940-L-ALD** (Alder)
- 14" H x 3" W x 9" Depth

(Measurements are approximate)

PLAIN CORBELS & BRACKETS

These ornaments are made of North American Hard Maple, Red Oak, Cherry, & Alder.



RWC945-S (Hard Maple)
RWC945-S-OAK (Red Oak)
RWC945-S-CH (Cherry)
RWC945-S-ALD (Alder)
 10" H x 2" W x 7" Depth

RWC945-M (Hard Maple)
RWC945-M-OAK (Red Oak)
RWC945-M-CH (Cherry)
RWC945-M-ALD (Alder)
 12" H x 2-1/2" W x 8" Depth

RWC945-L (Hard Maple)
RWC945-L-OAK (Red Oak)
RWC945-L-CH (Cherry)
RWC945-L-ALD (Alder)
 14" H x 3" W x 9" Depth

**Supplied with pre-attached keyhole hangers.*



RWC950-S (Hard Maple)
RWC950-S-OAK (Red Oak)
RWC950-S-CH (Cherry)
RWC950-S-ALD (Alder)
 10" H x 2" W x 7" Depth

RWC950-M (Hard Maple)
RWC950-M-OAK (Red Oak)
RWC950-M-CH (Cherry)
RWC950-M-ALD (Alder)
 12" H x 2-1/2" W x 8" Depth

RWC950-L (Hard Maple)
RWC950-L-OAK (Red Oak)
RWC950-L-CH (Cherry)
RWC950-L-ALD (Alder)
 14" H x 3" W x 9" Depth



RWC955-S (Hard Maple)
RWC955-S-OAK (Red Oak)
RWC955-S-CH (Cherry)
RWC955-S-ALD (Alder)
 10" H x 1-7/8" W x 7" Depth

RWC955-M (Hard Maple)
RWC955-M-OAK (Red Oak)
RWC955-M-CH (Cherry)
RWC955-M-ALD (Alder)
 12" H x 2-1/2" W x 8" Depth

RWC955-L (Hard Maple)
RWC955-L-OAK (Red Oak)
RWC955-L-CH (Cherry)
RWC955-L-ALD (Alder)
 14" H x 3" W x 9" Depth



RWC960-S (Hard Maple)
RWC960-S-OAK (Red Oak)
RWC960-S-CH (Cherry)
RWC960-S-ALD (Alder)
 10" H x 2" W x 7" Depth

RWC960-M (Hard Maple)
RWC960-M-OAK (Red Oak)
RWC960-M-CH (Cherry)
RWC960-M-ALD (Alder)
 12" H x 2-1/2" W x 8" Depth

RWC960-L (Hard Maple)
RWC960-L-OAK (Red Oak)
RWC960-L-CH (Cherry)
RWC960-L-ALD (Alder)
 14" H x 3-1/8" W x 9" Depth



(Measurements are approximate)

BRACKETS & CORBELS

These ornaments are made of
North American Hard Maple, Red Oak, Cherry & Alder.

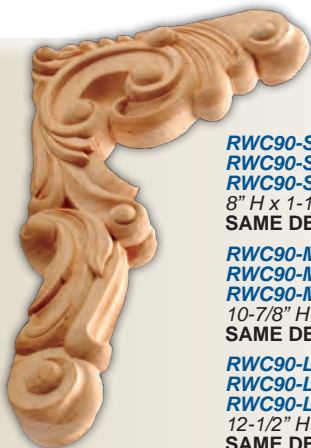

RWC90-S (Hard Maple)
RWC90-S-OAK (Red Oak)
RWC90-S-CH (Cherry)
8" H x 1-1/4" W x 4-3/4" Depth
SAME DESIGN ON BOTH SIDES

RWC90-M (Hard Maple)
RWC90-M-OAK (Red Oak)
RWC90-M-CH (Cherry)
10-7/8" H x 1-1/2" W x 6-3/8" Depth
SAME DESIGN ON BOTH SIDES

RWC90-L (Hard Maple)
RWC90-L-OAK (Red Oak)
RWC90-L-CH (Cherry)
12-1/2" H x 1-7/8" W x 7-1/2" Depth
SAME DESIGN ON BOTH SIDES



***RWC58-S** (Hard Maple)
***RWC58-S-OAK** (Red Oak)
***RWC58-S-CH** (Cherry)
7-1/2" H x 1-5/8" W x 4-5/8" Depth

***RWC58-M** (Hard Maple)
***RWC58-M-OAK** (Red Oak)
***RWC58-M-CH** (Cherry)
10-3/4" H x 2" W x 6-1/2" Depth

***RWC58-L** (Hard Maple)
***RWC58-L-OAK** (Red Oak)
***RWC58-L-CH** (Cherry)
12-3/8" H x 2-1/2" W x 7-1/2" Depth



***RWC328-S** (Hard Maple)
***RWC328-S-OAK** (Red Oak)
***RWC328-S-CH** (Cherry)
***RWC328-S-ALD** (Alder)
8" H x 3-5/8" W x 2-1/2" Depth

***RWC328-M** (Hard Maple)
***RWC328-M-OAK** (Red Oak)
***RWC328-M-CH** (Cherry)
***RWC328-M-ALD** (Alder)
10-1/2" H x 5" W x 3-1/4" Depth

***RWC328-L** (Hard Maple)
***RWC328-L-OAK** (Red Oak)
***RWC328-L-CH** (Cherry)
***RWC328-L-ALD** (Alder)
13" H x 5-7/8" W x 3-1/4" Depth

***Supplied with
pre-attached
keyhole hangers.**

***RWC52-S** (Hard Maple)
***RWC52-S-OAK** (Red Oak)
***RWC52-S-CH** (Cherry)
6" H x 1-3/4" W x 4-1/2" Depth

***RWC52-M** (Hard Maple)
***RWC52-M-OAK** (Red Oak)
***RWC52-M-CH** (Cherry)
9" H x 2" W x 6-3/4" Depth

***RWC52-L** (Hard Maple)
***RWC52-L-OAK** (Red Oak)
***RWC52-L-CH** (Cherry)
10-3/4" H x 2-1/2" W x 8-1/8" Depth



(Measurements are approximate)

CORBELS

These ornaments are made of North American Hard Maple, Red Oak, Cherry & Alder.



- *RWC318-XS (Hard Maple)
- *RWC318-XS-OAK (Red Oak)
- *RWC318-XS-CH (Cherry)
- *RWC318-XS-ALD (Alder)
- 5" H x 2-7/8" W x 2-7/8" Depth
- *RWC318-S (Hard Maple)
- *RWC318-S-OAK (Red Oak)
- *RWC318-S-CH (Cherry)
- *RWC318-S-ALD (Alder)
- 8" H x 3-7/8" W x 3-7/8" Depth
- *RWC318-M (Hard Maple)
- *RWC318-M-OAK (Red Oak)
- *RWC318-M-CH (Cherry)
- *RWC318-M-ALD (Alder)
- 10-1/2" H x 4-7/8" W x 4-7/8" Depth
- *RWC318-L (Hard Maple)
- *RWC318-L-OAK (Red Oak)
- *RWC318-L-CH (Cherry)
- *RWC318-L-ALD (Alder)
- 13" H x 5-1/4" W x 5-1/4" Depth
- *RWC318-XL (Hard Maple)
- *RWC318-XL-OAK (Red Oak)
- *RWC318-XL-CH (Cherry)
- *RWC318-XL-ALD (Alder)
- 15" H x 6" W x 6" Depth



- *RWC322-S (Hard Maple)
- *RWC322-S-OAK (Red Oak)
- *RWC322-S-CH (Cherry)
- *RWC322-S-ALD (Alder)
- 8" H x 2-1/2" W x 5-1/4" Depth
- *RWC322-M (Hard Maple)
- *RWC322-M-OAK (Red Oak)
- *RWC322-M-CH (Cherry)
- *RWC322-M-ALD (Alder)
- 11" H x 3-1/2" W x 7-1/4" Depth
- *RWC322-L (Hard Maple)
- *RWC322-L-OAK (Red Oak)
- *RWC322-L-CH (Cherry)
- *RWC322-L-ALD (Alder)
- 13" H x 4" W x 8-1/2" Depth

***Supplied with pre-attached keyhole hangers.**

- *RWC319-S (Hard Maple)
- *RWC319-S-OAK (Red Oak)
- *RWC319-S-CH (Cherry)
- *RWC319-S-ALD (Alder)
- 8" H x 3-5/8" W x 2-3/8" Depth
- *RWC319-M (Hard Maple)
- *RWC319-M-OAK (Red Oak)
- *RWC319-M-CH (Cherry)
- *RWC319-M-ALD (Alder)
- 10-1/2" H x 5" W x 3-1/4" Depth
- *RWC319-L (Hard Maple)
- *RWC319-L-OAK (Red Oak)
- *RWC319-L-CH (Cherry)
- *RWC319-L-ALD (Alder)
- 13" H x 5-1/2" W x 3-3/4" Depth



- *RWC325-S (Hard Maple)
- *RWC325-S-OAK (Red Oak)
- *RWC325-S-CH (Cherry)
- 11" H x 3-1/2" W x 7-1/4" Depth
- *RWC325-L (Hard Maple)
- *RWC325-L-OAK (Red Oak)
- *RWC325-L-CH (Cherry)
- 13" H x 4" W x 8-1/2" Depth



- RWC346-S (Hard Maple)
- RWC346-S-OAK (Red Oak)
- RWC346-S-CH (Cherry)
- 13" H x 4-1/8" W x 3-3/4" Depth
- RWC346-M (Hard Maple)
- RWC346-M-OAK (Red Oak)
- RWC346-M-CH (Cherry)
- 20" H x 5-1/2" W x 5-7/8" Depth
- RWC346-L (Hard Maple)
- RWC346-L-OAK (Red Oak)
- RWC346-L-CH (Cherry)
- 26-1/2" H x 6-3/8" W x 7-3/4" Depth



- *RWC320-S (Hard Maple)
- *RWC320-S-OAK (Red Oak)
- *RWC320-S-CH (Cherry)
- *RWC320-S-ALD (Alder)
- 8" H x 2-1/2" W x 5-1/4" Depth
- *RWC320-M (Hard Maple)
- *RWC320-M-OAK (Red Oak)
- *RWC320-M-CH (Cherry)
- *RWC320-M-ALD (Alder)
- 11" H x 3-1/2" W x 7-1/4" Depth
- *RWC320-L (Hard Maple)
- *RWC320-L-OAK (Red Oak)
- *RWC320-L-CH (Cherry)
- *RWC320-L-ALD (Alder)
- 13" H x 4" W x 9" Depth

(Measurements are approximate)

CORBELS

These ornaments are made of North American Hard Maple, Red Oak, Cherry & Alder.



- *RWC39-S (Hard Maple)
- *RWC39-S-OAK (Red Oak)
- *RWC39-S-CH (Cherry)
- *RWC39-S-ALD (Alder)
- 8-1/4" H x 3-3/4" W x 2-5/8" Depth
- *RWC39-M (Hard Maple)
- *RWC39-M-OAK (Red Oak)
- *RWC39-M-CH (Cherry)
- *RWC39-M-ALD (Alder)
- 10-1/2" H x 4-7/8" W x 3-1/2" Depth
- *RWC39-L (Hard Maple)
- *RWC39-L-OAK (Red Oak)
- *RWC39-L-CH (Cherry)
- *RWC39-L-ALD (Alder)
- 13" H x 5-3/8" W x 4-1/2" Depth

**Supplied with pre-attached keyhole hangers.*



- *RWC37-XS (Hard Maple)
- *RWC37-XS-OAK (Red Oak)
- *RWC37-XS-CH (Cherry)
- *RWC37-XS-ALD (Alder)
- 4-3/4" H x 2-7/8" W x 2-5/8" Depth
- *RWC37-S (Hard Maple)
- *RWC37-S-OAK (Red Oak)
- *RWC37-S-CH (Cherry)
- *RWC37-S-ALD (Alder)
- 7-1/8" H x 3-5/8" W x 3-5/8" Depth
- *RWC37-M (Hard Maple)
- *RWC37-M-OAK (Red Oak)
- *RWC37-M-CH (Cherry)
- *RWC37-M-ALD (Alder)
- 10-1/2" H x 4-7/8" W x 5-1/4" Depth
- *RWC37-L (Hard Maple)
- *RWC37-L-OAK (Red Oak)
- *RWC37-L-CH (Cherry)
- *RWC37-L-ALD (Alder)
- 12-1/2" H x 5-3/8" W x 5-5/8" Depth
- RWC37-XL (Hard Maple)
- *RWC37-XL-OAK (Red Oak)
- *RWC37-XL-CH (Cherry)
- *RWC37-XL-ALD (Alder)
- 14-1/2" H x 5-3/4" W x 6-5/8" Depth
- *RWC37-XXL (Hard Maple)
- *RWC37-XXL-OAK (Red Oak)
- *RWC37-XXL-CH (Cherry)
- *RWC37-XXL-ALD (Alder)
- 26-1/2" H x 8-1/4" W x 8-3/4" Depth
- *RWC37-XXXL (Hard Maple)
- *RWC37-XXXL-OAK (Red Oak)
- *RWC37-XXXL-CH (Cherry)
- 36" H x 10" W x 11-3/8" Depth



- *RWC37-BASE36 (Hard Maple)
- *RWC37-BASE36-OAK (Red Oak)
- *RWC37-BASE36-CH (Cherry)
- *RWC37-BASE36-ALD (Alder)
- 36" H x 7" W x 7-1/2" Depth
- *RWC37-BASE42 (Hard Maple)
- *RWC37-BASE42-OAK (Red Oak)
- *RWC37-BASE42-CH (Cherry)
- *RWC37-BASE42-ALD (Alder)
- 42" H x 7-1/2" W x 8" Depth

(Measurements are approximate)

CORBELS

These ornaments are made of North American Hard Maple, Red Oak, Cherry & Alder.

- *RWC54-S (Hard Maple)
- *RWC54-S-OAK (Red Oak)
- *RWC54-S-CH (Cherry)
- *RWC54-S-ALD (Alder)
- 10-1/2" H x 3-3/8" W x 6-1/2" Depth
- *RWC54-L (Hard Maple)
- *RWC54-L-OAK (Red Oak)
- *RWC54-L-CH (Cherry)
- *RWC54-L-ALD (Alder)
- 13-1/4" H x 3-7/8" x 8-1/4" Depth



- *RWC57-S (Hard Maple)
- *RWC57-S-OAK (Red Oak)
- *RWC57-S-CH (Cherry)
- *RWC57-S-ALD (Alder)
- 8" H x 2" W x 4-3/4" Depth
- *RWC57-M (Hard Maple)
- *RWC57-M-OAK (Red Oak)
- *RWC57-M-CH (Cherry)
- *RWC57-M-ALD (Alder)
- 10-13/16" H x 2-1/8" W x 6-11/16" Depth
- *RWC57-L (Hard Maple)
- *RWC57-L-OAK (Red Oak)
- *RWC57-L-CH (Cherry)
- *RWC57-L-ALD (Alder)
- 12-3/8" H x 2-7/8" W x 7-3/8" Depth



- *RWC307-XS (Hard Maple)
- *RWC307-XS-OAK (Red Oak)
- *RWC307-XS-CH (Cherry)
- 5" H x 2-3/4" W x 2-3/8" Depth
- *RWC307-S (Hard Maple)
- *RWC307-S-OAK (Red Oak)
- *RWC307-S-CH (Cherry)
- 7-1/4" H x 3-1/2" W x 3-3/8" Depth
- *RWC307-L (Hard Maple)
- *RWC307-L-OAK (Red Oak)
- *RWC307-L-CH (Cherry)
- 12-1/2" H x 5-1/4" W x 5-3/8" Depth
- *RWC307-XL (Hard Maple)
- *RWC307-XL-OAK (Red Oak)
- *RWC307-XL-CH (Cherry)
- 14-1/2" H x 6" W x 6-1/8" Depth



- *RWC313-S (Hard Maple)
- *RWC313-S-OAK (Red Oak)
- *RWC313-S-CH (Cherry)
- 11" H x 3-1/2" W x 6-3/4" Depth
- *RWC313-L (Hard Maple)
- *RWC313-L-OAK (Red Oak)
- *RWC313-L-CH (Cherry)
- 13-1/4" H x 4" W x 8-1/4" Depth

***Supplied with pre-attached keyhole hangers.**

- *RWC316-M (Hard Maple)
- *RWC316-M-OAK (Red Oak)
- *RWC316-M-CH (Cherry)
- 11" H x 3-1/2" W x 6-3/4" Depth
- *RWC316-L (Hard Maple)
- *RWC316-L-OAK (Red Oak)
- *RWC316-L-CH (Cherry)
- 13-1/4" H x 4" W x 8-1/4" Depth



- *RWC310-M (Hard Maple)
- *RWC310-M-OAK (Red Oak)
- *RWC310-M-CH (Cherry)
- 10-1/2" H x 4-7/8" W x 3-1/4" Depth



(Measurements are approximate)

CORBELS

These ornaments are made of North American Hard Maple, Red Oak, Cherry & Alder.



- *RWC40-XS (Hard Maple)
- *RWC40-XS-OAK (Red Oak)
- *RWC40-XS-CH (Cherry)
- 6-7/8" H x 3-1/8" W x 3-1/2" Depth
- *RWC40-S (Hard Maple)
- *RWC40-S-OAK (Red Oak)
- *RWC40-S-CH (Cherry)
- 10-1/4" H x 5-1/8" W x 4-7/8" Depth
- *RWC40-M (Hard Maple)
- *RWC40-M-OAK (Red Oak)
- *RWC40-M-CH (Cherry)
- 12-3/8" H x 5" W x 5-3/8" Depth
- *RWC40-L (Hard Maple)
- *RWC40-L-OAK (Red Oak)
- *RWC40-L-CH (Cherry)
- 14-1/4" H x 5-1/8" W x 5-1/2" Depth



- *RWC07-S (Hard Maple)
- *RWC07-S-OAK (Red Oak)
- *RWC07-S-CH (Cherry)
- 8 H x 3-7/8" W x 2-3/4" Depth
- *RWC07-M (Hard Maple)
- *RWC07-M-OAK (Red Oak)
- *RWC07-M-CH (Cherry)
- 10-1/8" H x 5" W x 3-1/2" Depth
- *RWC07-L (Hard Maple)
- *RWC07-L-OAK (Red Oak)
- *RWC07-L-CH (Cherry)
- 12-5/8" H x 6-3/8" W x 4-1/2" Depth

- *RWC40-XL (Hard Maple)
- *RWC40-XL-OAK (Red Oak)
- *RWC40-XL-CH (Cherry)
- 26-1/2" H x 7-3/8" W x 8-1/2" Depth

***Supplied with pre-attached keyhole hangers.**



- *RWC56-S (Hard Maple)
- *RWC56-S-OAK (Red Oak)
- *RWC56-S-CH (Cherry)
- 10-1/2" H x 3-1/4" W x 6-3/4" Depth
- *RWC56-L (Hard Maple)
- *RWC56-L-OAK (Red Oak)
- *RWC56-L-CH (Cherry)
- 13-1/4" H x 3-3/4" W x 8-3/8" Depth



- *RWC55-S (Hard Maple)
- *RWC55-S-OAK (Red Oak)
- *RWC55-S-CH (Cherry)
- 7-1/2" H x 1-3/4" W x 4-1/2" Depth
- *RWC55-M (Hard Maple)
- *RWC55-M-OAK (Red Oak)
- *RWC55-M-CH (Cherry)
- 10-5/8" H x 2-1/8" W x 6-3/4" Depth
- *RWC55-L (Hard Maple)
- *RWC55-L-OAK (Red Oak)
- *RWC55-L-CH (Cherry)
- 12-3/8" H x 2-1/2" W x 7-5/8" Depth

(Measurements are approximate)

CORBELS

These ornaments are made of North American Hard Maple, Red Oak, Cherry & Alder.



- *RWC47-XS (Hard Maple)
- *RWC47-XS-OAK (Red Oak)
- *RWC47-XS-CH (Cherry)
- 8" H x 3-7/8" W x 4" Depth
- *RWC47-S (Hard Maple)
- *RWC47-S-OAK (Red Oak)
- *RWC47-S-CH (Cherry)
- 10-1/2" H x 5-1/8" W x 5-1/4" Depth
- *RWC47-M (Hard Maple)
- *RWC47-M-OAK (Red Oak)
- *RWC47-M-CH (Cherry)
- 12" H x 5" W x 5-3/4" Depth
- *RWC47-L (Hard Maple)
- *RWC47-L-OAK (Red Oak)
- *RWC47-L-CH (Cherry)
- 14-1/4" H x 5-1/2" W x 7" Depth



- *RWC53-S (Hard Maple)
- *RWC53-S-OAK (Red Oak)
- *RWC53-S-CH (Cherry)
- 10-5/8" H x 3-3/4" W x 6-1/2" Depth
- *RWC53-L (Hard Maple)
- *RWC53-L-OAK (Red Oak)
- *RWC53-L-CH (Cherry)
- 13-1/8" H x 4" W x 8-1/4" Depth

**Supplied with pre-attached keyhole hangers.*



- *RWC47-XL (Hard Maple)
- *RWC47-XL-OAK (Red Oak)
- *RWC47-XL-CH (Cherry)
- 26-1/2" H x 7-3/8" W x 8-3/8" Depth



- *RWC51-XS (Hard Maple)
- *RWC51-XS-OAK (Red Oak)
- *RWC51-XS-CH (Cherry)
- 3-1/2" H x 1-7/8" W x 1-7/8" Depth
- *RWC51-M (Hard Maple)
- *RWC51-M-OAK (Red Oak)
- *RWC51-M-CH (Cherry)
- 7-1/2" H x 4-1/2" W x 4-1/4" Depth
- *RWC51-XL (Hard Maple)
- *RWC51-XL-OAK (Red Oak)
- *RWC51-XL-CH (Cherry)
- 10-7/8" H x 6-1/2" W x 6-3/8" Depth

- *RWC51-S (Hard Maple)
- *RWC51-S-OAK (Red Oak)
- *RWC51-S-CH (Cherry)
- 5-7/8" H x 3-1/2" W x 3-5/8" Depth
- *RWC51-L (Hard Maple)
- *RWC51-L-OAK (Red Oak)
- *RWC51-L-CH (Cherry)
- 9-5/8" H x 5-3/4" W x 5-3/8" Depth

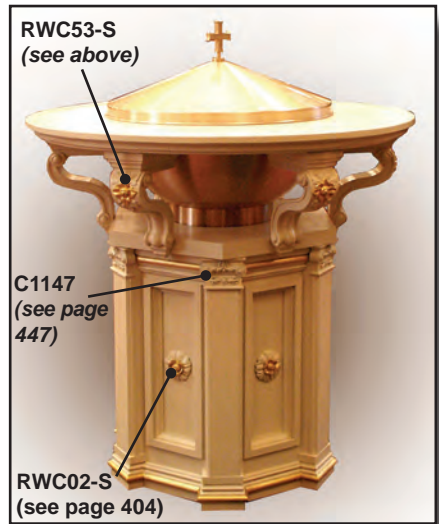

(Measurements are approximate)

CORBELS

These ornaments are made of North American Hard Maple, Red Oak, Cherry & Alder.



- *RWC34-S (Hard Maple)
- *RWC34-S-OAK (Red Oak)
- *RWC34-S-CH (Cherry)
- 7-5/8" H x 3-7/8" W x 3-3/4" Depth
- *RWC34-L (Hard Maple)
- *RWC34-L-OAK (Red Oak)
- *RWC34-L-CH (Cherry)
- 9-5/8" H x 6-3/4" W x 6-1/4" Depth



- RWC364-S (Hard Maple)
- RWC364-S-OAK (Red Oak)
- RWC364-S-CH (Cherry)
- RWC364-S-ALD (Alder)
- 2-7/8" H x 2" W x 1" Depth
- RWC364-L (Hard Maple)
- RWC364-L-OAK (Red Oak)
- RWC364-L-CH (Cherry)
- RWC364-L-ALD (Alder)
- 4-1/8" H x 2" W x 1-3/8" Depth

- *RWC46-S (Hard Maple)
- *RWC46-S-OAK (Red Oak)
- *RWC46-S-CH (Cherry)
- 5" H x 3-1/2" W x 1-3/4" Depth
- *RWC46-M (Hard Maple)
- *RWC46-M-OAK (Red Oak)
- *RWC46-M-CH (Cherry)
- 6-3/8" H x 4-5/8" W x 2-3/8" Depth
- *RWC46-L (Hard Maple)
- *RWC46-L-OAK (Red Oak)
- *RWC46-L-CH (Cherry)
- 7-3/4" H x 5-1/2" W x 2-7/8" Depth



- *RWC43-S (Hard Maple)
- *RWC43-S-OAK (Red Oak)
- *RWC43-S-CH (Cherry)
- 4-3/8" H x 3-1/2" W x 1-3/4" Depth
- *RWC43-M (Hard Maple)
- *RWC43-M-OAK (Red Oak)
- *RWC43-M-CH (Cherry)
- 5-1/2" H x 4-1/2" W x 2-1/4" Depth
- *RWC43-L (Hard Maple)
- *RWC43-L-OAK (Red Oak)
- *RWC43-L-CH (Cherry)
- 6-3/4" H x 5-1/2" W x 2-3/4" Depth



***Supplied with pre-attached keyhole hangers.**



- *RWC50-S (Hard Maple)
- *RWC50-S-OAK (Red Oak)
- *RWC50-S-CH (Cherry)
- 4" H x 2-3/4" W x 2-1/4" Depth
- *RWC50-L (Hard Maple)
- *RWC50-L-OAK (Red Oak)
- *RWC50-L-CH (Cherry)
- 8" H x 5-1/2" W x 4-3/8" Depth
- *RWC50-M (Hard Maple)
- *RWC50-M-OAK (Red Oak)
- *RWC50-M-CH (Cherry)
- 6-1/4" H x 4-1/4" W x 3-3/8" Depth
- *RWC50-XL (Hard Maple)
- *RWC50-XL-OAK (Red Oak)
- *RWC50-XL-CH (Cherry)
- 10-7/8" H x 7" W x 6-1/4" Depth



- *RWC06-S (Hard Maple)
- *RWC06-S-OAK (Red Oak)
- *RWC06-S-CH (Cherry)
- 4" H x 2-7/8" W x 1-1/2" Depth
- *RWC06-M (Hard Maple)
- *RWC06-M-OAK (Red Oak)
- *RWC06-M-CH (Cherry)
- 5-3/8" H x 3-3/4" W x 2" Depth
- *RWC06-L (Hard Maple)
- *RWC06-L-OAK (Red Oak)
- *RWC06-L-CH (Cherry)
- 6-5/8" H x 4-5/8" W x 2-1/2" Depth

(Measurements are approximate)

CORBELS

These ornaments are made of North American Hard Maple, Red Oak, Cherry & Alder.



- *RWC349-XS (Hard Maple)
- *RWC349-XS-OAK (Red Oak)
- *RWC349-XS-CH (Cherry)
- *RWC349-XS-ALD (Alder)
- 8" H x 3-3/4" W x 2-1/2" Depth
- *RWC349-S (Hard Maple)
- *RWC349-S-OAK (Red Oak)
- *RWC349-S-CH (Cherry)
- *RWC349-S-ALD (Alder)
- 10" H x 4-1/2" W x 3-1/4" Depth
- *RWC349-L (Hard Maple)
- *RWC349-L-OAK (Red Oak)
- *RWC349-L-CH (Cherry)
- *RWC349-L-ALD (Alder)
- 12-1/4" H x 5-3/8" W x 3-7/8" Depth
- *RWC349-XL (Hard Maple)
- *RWC349-XL-OAK (Red Oak)
- *RWC349-XL-CH (Cherry)
- *RWC349-XL-ALD (Alder)
- 14-5/8" H x 6-3/8" W x 4-5/8" Depth
- *RWC349-XXL (Hard Maple)
- *RWC349-XXL-OAK (Red Oak)
- *RWC349-XXL-CH (Cherry)
- *RWC349-XXL-ALD (Alder)
- 18" H x 7-1/2" W x 5-1/2" Depth

***Supplied with pre-attached keyhole hangers.**

- *RWC361-S (Hard Maple)
- *RWC361-S-OAK (Red Oak)
- *RWC361-S-CH (Cherry)
- *RWC361-S-ALD (Alder)
- 6-1/8" H x 3-1/8" W x 1-7/8" Depth
- *RWC361-L (Hard Maple)
- *RWC361-L-OAK (Red Oak)
- *RWC361-L-CH (Cherry)
- *RWC361-L-ALD (Alder)
- 9-1/8" H x 4-5/8" W x 2-3/4" Depth

- RWC358-S (Hard Maple)
- RWC358-S-OAK (Red Oak)
- RWC358-S-CH (Cherry)
- 4-7/8" H x 2-1/2" W x 1-3/8" Depth
- RWC358-L (Hard Maple)
- RWC358-L-OAK (Red Oak)
- RWC358-L-CH (Cherry)
- 6-3/4" H x 3-5/8" W x 2" Depth



- *RWC352-S (Hard Maple)
- *RWC352-S-OAK (Red Oak)
- *RWC352-S-CH (Cherry)
- 8" H x 3-3/8" W x 2-1/2" Depth
- *RWC352-M (Hard Maple)
- *RWC352-M-OAK (Red Oak)
- *RWC352-M-CH (Cherry)
- 10-1/2" H x 4-7/8" W x 3-1/4" Depth
- *RWC352-L (Hard Maple)
- *RWC352-L-OAK (Red Oak)
- *RWC352-L-CH (Cherry)
- 13" H x 5-1/2" W x 4" Depth

- *RWC337-S (Hard Maple)
- *RWC337-S-OAK (Red Oak)
- *RWC337-S-CH (Cherry)
- 8" H x 4" W x 8" Depth
- *RWC337-M (Hard Maple)
- *RWC337-M-OAK (Red Oak)
- *RWC337-M-CH (Cherry)
- 10" H x 5" W x 10" Depth



(Measurements are approximate)

CORBELS

These ornaments are made of North American Hard Maple, Red Oak, Cherry & Alder.



- *RWC304-S (Hard Maple)
- *RWC304-S-OAK (Red Oak)
- *RWC304-S-CH (Cherry)
- *RWC304-S-ALD (Alder)
- 8" H x 2-1/2" W x 5" Depth
- *RWC304-M (Hard Maple)
- *RWC304-M-OAK (Red Oak)
- *RWC304-M-CH (Cherry)
- *RWC304-M-ALD (Alder)
- 11" H x 3-1/2" W x 7-1/8" Depth
- *RWC304-L (Hard Maple)
- *RWC304-L-OAK (Red Oak)
- *RWC304-L-CH (Cherry)
- *RWC304-L-ALD (Alder)
- 13" H x 4" W x 8-1/2" Depth

- *RWC301-S (Hard Maple)
- *RWC301-S-OAK (Red Oak)
- *RWC301-S-CH (Cherry)
- 8" H x 2-1/2" W x 5" Depth
- *RWC301-M (Hard Maple)
- *RWC301-M-OAK (Red Oak)
- *RWC301-M-CH (Cherry)
- 11" H x 3-1/2" W x 7-1/8" Depth
- *RWC301-L (Hard Maple)
- *RWC301-L-OAK (Red Oak)
- *RWC301-L-CH (Cherry)
- 13" H x 4-3/4" W x 8-1/2" Depth



Acanthus Leaf

- RWC367-S (Hard Maple)
- RWC367-S-OAK (Red Oak)
- RWC367-S-CH (Cherry)
- 6-1/4" H x 2-7/8" W x 5" Projection
- RWC367-M (Hard Maple)
- RWC367-M-OAK (Red Oak)
- RWC367-M-CH (Cherry)
- 8-3/8" H x 3-3/4" W x 6-5/8" Projection
- RWC367-L (Hard Maple)
- RWC367-L-OAK (Red Oak)
- RWC367-L-CH (Cherry)
- 10" H x 4-1/2" W x 7-7/8" Projection



*Supplied with pre-attached keyhole hangers.

PLEASE NOTE:
To view leaf style of #RWC355, see #RWC367.

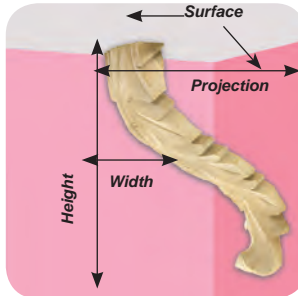

Acanthus Leaf w/Bracket

- *RWC355-S (Hard Maple)
- *RWC355-S-OAK (Red Oak)
- *RWC355-S-CH (Cherry)
- 8-1/4" H x 5" W x 6-3/4" Depth
- *RWC355-M (Hard Maple)
- *RWC355-M-OAK (Red Oak)
- *RWC355-M-CH (Cherry)
- 10-3/4" H x 6-1/4" W x 8-5/8" Depth
- *RWC355-L (Hard Maple)
- *RWC355-L-OAK (Red Oak)
- *RWC355-L-CH (Cherry)
- 12-1/2" H x 7" W x 10" Depth

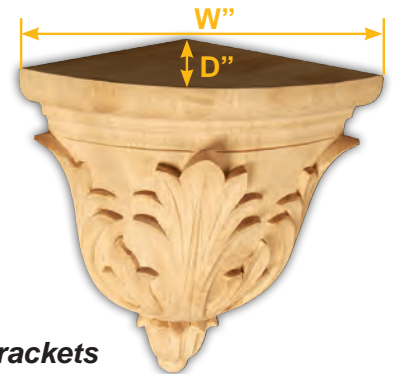

Corner Brackets

- *RWC36-S (Hard Maple)
- *RWC36-S-OAK (Red Oak)
- *RWC36-S-CH (Cherry)
- 8-1/4" H x 5-1/4" W x 5-1/2" Depth
- *RWC36-L (Hard Maple)
- *RWC36-L-OAK (Red Oak)
- *RWC36-L-CH (Cherry)
- 11-3/4" H x 10-1/2" W x 7-1/2" Depth

(Measurements are approximate)

CORBELS

These ornaments are made of North American Hard Maple, Red Oak, Cherry & Alder.



- *RWC41-XS (Hard Maple)
- *RWC41-XS-OAK (Red Oak)
- *RWC41-XS-CH (Cherry)
- *RWC41-XS-ALD (Alder)
- 6-3/4" H x 3-3/8" W x 3-3/4" Depth
- *RWC41-S (Hard Maple)
- *RWC41-S-OAK (Red Oak)
- *RWC41-S-CH (Cherry)
- *RWC41-S-ALD (Alder)
- 10" H x 4-3/4" W x 5-3/8" Depth
- *RWC41-M (Hard Maple)
- *RWC41-M-OAK (Red Oak)
- *RWC41-M-CH (Cherry)
- *RWC41-M-ALD (Alder)
- 12-1/2" H x 5-1/8" W x 5-3/8" Depth
- *RWC41-L (Hard Maple)
- *RWC41-L-OAK (Red Oak)
- *RWC41-L-CH (Cherry)
- *RWC41-L-ALD (Alder)
- 14-3/8" H x 5-3/4" W x 5-5/8" Depth
- *RWC41-XL (Hard Maple)
- *RWC41-XL-OAK (Red Oak)
- *RWC41-XL-CH (Cherry)
- *RWC41-XL-ALD (Alder)
- 26-1/2" H x 7-3/8" W x 8-1/2" Depth
- *RWC41-XXL (Hard Maple)
- *RWC41-XXL-OAK (Red Oak)
- *RWC41-XXL-CH (Cherry)
- *RWC41-XXL-ALD (Alder)
- 36" H x 10" W x 11-1/4" Depth



- *RWC42-XS (Hard Maple)
- *RWC42-XS-OAK (Red Oak)
- *RWC42-XS-CH (Cherry)
- 8" H x 3-7/8" W x 3-7/8" Depth
- *RWC42-S (Hard Maple)
- *RWC42-S-OAK (Red Oak)
- *RWC42-S-CH (Cherry)
- 10-1/2" H x 5-1/8" W x 5-1/4" Depth
- *RWC42-M (Hard Maple)
- *RWC42-M-OAK (Red Oak)
- *RWC42-M-CH (Cherry)
- 12-3/8" H x 5-1/8" W x 5-1/4" Depth
- *RWC42-L (Hard Maple)
- *RWC42-L-OAK (Red Oak)
- *RWC42-L-CH (Cherry)
- 14-1/4" H x 5-1/2" W x 6-5/8" Depth

***Supplied with pre-attached keyhole hangers.**



- *RWC41-BASE36 (Hard Maple)
- *RWC41-BASE36-OAK (Red Oak)
- *RWC41-BASE36-CH (Cherry)
- *RWC41-BASE36-ALD (Alder)
- 36" H x 7" W x 7-1/2" Depth
- *RWC41-BASE42 (Hard Maple)
- *RWC41-BASE42-OAK (Red Oak)
- *RWC41-BASE42-CH (Cherry)
- *RWC41-BASE42-ALD (Alder)
- 42" H x 7-1/2" W x 8" Depth



(Measurements are approximate)

CORBELS

These ornaments are made of North American Hard Maple, Red Oak, Cherry & Alder.



- *RWC48-XS (Hard Maple)
- *RWC48-XS-OAK (Red Oak)
- *RWC48-XS-CH (Cherry)
- *RWC48-XS-ALD (Alder)
- 7-1/8" H x 2-3/8" W x 1-3/8" Depth
- *RWC48-S (Hard Maple)
- *RWC48-S-OAK (Red Oak)
- *RWC48-S-CH (Cherry)
- *RWC48-S-ALD (Alder)
- 11-1/4" H x 4-3/8" W x 2-1/4" Depth
- *RWC48-M (Hard Maple)
- *RWC48-M-OAK (Red Oak)
- *RWC48-M-CH (Cherry)
- *RWC48-M-ALD (Alder)
- 15-3/8" H x 5-7/8" W x 2-5/8" Depth

- *RWC03-S (Hard Maple)
- *RWC03-S-OAK (Red Oak)
- *RWC03-S-CH (Cherry)
- 8" H x 4-1/4" W x 3-3/8" Depth
- *RWC03-M (Hard Maple)
- *RWC03-M-OAK (Red Oak)
- *RWC03-M-CH (Cherry)
- 10" H x 5-3/8" W x 4-3/8" Depth
- *RWC03-L (Hard Maple)
- *RWC03-L-OAK (Red Oak)
- *RWC03-L-CH (Cherry)
- 12-1/2" H x 6-3/4" W x 5-1/8" Depth
- *RWC03-XL (Hard Maple)
- *RWC03-XL-OAK (Red Oak)
- *RWC03-XL-CH (Cherry)
- 14-3/4" H x 7-7/8" W x 6-1/8" Depth



- *RWC48-L (Hard Maple)
- *RWC48-L-OAK (Red Oak)
- *RWC48-L-CH (Cherry)
- *RWC48-L-ALD (Alder)
- 24" H x 6-7/8" W x 3-1/2" Depth
- *RWC48-XL (Hard Maple)
- *RWC48-XL-OAK (Red Oak)
- *RWC48-XL-CH (Cherry)
- *RWC48-XL-ALD (Alder)
- 35-7/8" H x 8-1/2" W x 4-1/2" Depth



FOR THIS DESIGN IN RESIN, SEE PAGE 448.

*Supplied with pre-attached keyhole hangers.

- *RWC331-S (Hard Maple)
- *RWC331-S-OAK (Red Oak)
- *RWC331-S-CH (Cherry)
- *RWC331-S-ALD (Alder)
- 10-1/8" H x 3-1/8" W x 2-5/8" Depth
- *RWC331-M (Hard Maple)
- *RWC331-M-OAK (Red Oak)
- *RWC331-M-CH (Cherry)
- *RWC331-M-ALD (Alder)
- 12" H x 3-5/8" W x 3-1/4" Depth
- *RWC331-L (Hard Maple)
- *RWC331-L-OAK (Red Oak)
- *RWC331-L-CH (Cherry)
- *RWC331-L-ALD (Cherry)
- 14" H x 4-3/8" W x 3-3/4" Depth

- *RWC331-XL (Hard Maple)
- *RWC331-XL-OAK (Red Oak)
- *RWC331-XL-CH (Cherry)
- *RWC331-XL-ALD (Alder)
- 24" H x 7-1/8" W x 6" Depth
- *RWC331-XXL (Hard Maple)
- *RWC331-XXL-OAK (Red Oak)
- *RWC331-XXL-CH (Cherry)
- *RWC331-XXL-ALD (Alder)
- 36" H x 10-3/4" W x 9" Depth

(Measurements are approximate)

ROYAL WOOD COLLECTION

These ornaments are made of North American Hard Maple, Red Oak, Cherry & Alder.

ROSETTES

3/4" x 2-3/4" x 2-3/4"



ADM801-PG
ADM801-RO
ADM801-MP

7/8" x 3-1/2" x 3-1/2"



ADM850-PG
ADM850-RO
ADM850-MP

7/8" x 4-1/2" x 4-1/2"



ADM803-PG
ADM803-RO
ADM803-MP

FILLER MOULDINGS

• 8 Ft. Lengths
• Two Sided, one Fluted, one Beaded
Accommodates 2 sizes - 2-3/4" and 3-3/4" Collars



2-3/4" Collars

13/16" x 2-1/4", no design repeat
ADM149-POP
ADM149-RO
ADM149-MP

3-3/4" Collars

13/16" x 3-1/4", no design repeat
ADM150-POP
ADM150-RO
ADM150-MP



(Fluted)



(Beaded)

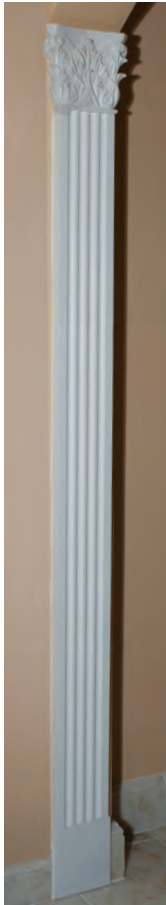

RWC119-S (Hard Maple)
RWC119-S-OAK (Red Oak)
RWC119-S-CH (Cherry)
RWC119-S-ALD (Alder)
4" H x 3-7/8" W x 1" Depth
2-3/4" Collar

RWC119-M (Hard Maple)
RWC119-M-OAK (Red Oak)
RWC119-M-CH (Cherry)
RWC119-M-ALD (Alder)
5-3/8" H x 5-1/4" W x 1-1/8" Depth
3-3/4" Collar

* RWC119-L (Hard Maple)
* RWC119-L-OAK (Red Oak)
* RWC119-L-CH (Cherry)
* RWC119-L-ALD (Alder)
6-1/4" H x 6-1/8" W x 1-1/4" Depth

* RWC119-XL (Hard Maple)
* RWC119-XL-OAK (Red Oak)
* RWC119-XL-CH (Cherry)
* RWC119-XL-ALD (Alder)
8-1/8" H x 8-1/8" W x 1-5/8" Depth



RWC113-S (Hard Maple)
RWC113-S-OAK (Red Oak)
RWC113-S-CH (Cherry)
RWC113-S-ALD (Alder)
5-1/2" H x 3-1/4" W x 1" Depth
2-3/4" Collar

RWC113-L (Hard Maple)
RWC113-L-OAK (Red Oak)
RWC113-L-CH (Cherry)
RWC113-L-ALD (Alder)
7-1/2" H x 4-1/2" W x 1-1/4" Depth
3-3/4" Collar



RWC122-S (Hard Maple)
RWC122-S-OAK (Red Oak)
RWC122-S-CH (Cherry)
3-3/8" H x 4-1/8" W x 1-3/8" Depth
2-3/4" Collar

RWC122-L (Hard Maple)
RWC122-L-OAK (Red Oak)
RWC122-L-CH (Cherry)
4-3/4" H x 5-5/8" W x 1-3/4" Depth
3-3/4" Collar



RWC116-S (Hard Maple)
RWC116-S-OAK (Red Oak)
RWC116-S-CH (Cherry)
3" H x 6-7/8" W x 1-5/8" Depth
2-3/4" Collar

RWC116-M (Hard Maple)
RWC116-M-OAK (Red Oak)
RWC116-M-CH (Cherry)
4" H x 9-1/4" W x 2" Depth
3-3/4" Collar

* RWC116-L (Hard Maple)
* RWC116-L-OAK (Red Oak)
* RWC116-L-CH (Cherry)
4-5/8" H x 10-3/8" W x 2-3/8" Depth

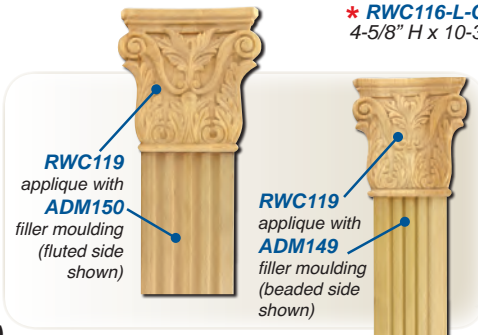

RWC119
applique with
ADM150
filler moulding
(fluted side
shown)

RWC119
applique with
ADM149
filler moulding
(beaded side
shown)

(Measurements are approximate)

* These items do not accommodate filler mouldings.

CUSTOM CARVED WOOD PROGRAM



Take Advantage of our
**AFFORDABLE CUSTOM
CARVED WOOD PROGRAM**

BUY DIRECT & SAVE

Custom Designs available in
Solid North American Hardwood Hard Maple, Red Oak, Cherry and Alder

Send us a sample or a drawing
Tooling charges will range - please inquire

How Does The Custom Carved Wood Program Work?

Part 1

Option A

Customer must submit a true to size and detailed 1:1 scale drawing with front & side elevations. (All dimensions needed Length x Width x Depth).

Option B

An actual sample is submitted and used as a reference.

*Note: There will be a slight variation from the original sample sent to the carver due to the pieces being individually hand carved and the artisan's interpretation.

Also include species of wood (Hard Maple, Red Oak, Cherry or Alder) and approximate quantity needed.

Part 2

A quote will be provided within approximately 48 hours once all necessary information has been submitted to our Artisans.

Part 3

Once the quote has been approved by the customer, production of the prototype will begin. Additional shipping options and charges may apply. Please inquire.

Part 4

Once the prototype has been approved by the customer, final production will begin. Once again, lead times will vary according to quantity, size and detail.

Please contact our sales department with any questions concerning information needed for quotation purposes.

NOTE: ACCEPTANCE OF ORDERS ARE SUBJECT TO INTERNATIONAL COPYRIGHT LAWS.

APPLIQUES

These ornaments are made of Medium Density Light Grain White Wood. (Similar to Basswood)

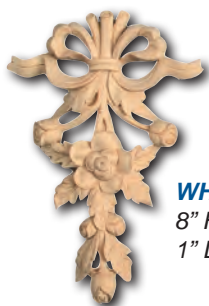

WHC60
8" H x 5-1/2" W
1" Depth



WHC66
4-1/2" H x 12" W
1-1/4" Depth

WHC65
6" H x 16" W
1-3/8" Depth

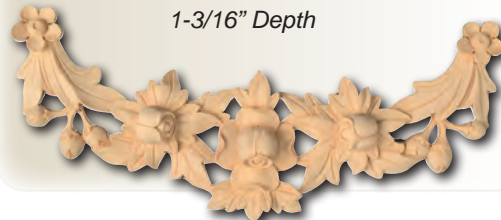

WHC62
6-5/16" H x 14-3/8" W
1-3/16" Depth

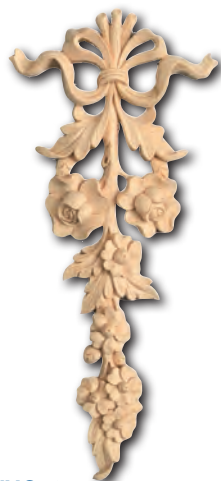

WHC59
14-1/4" H x 6-5/8" W
1" Depth



WHC85
10-1/2" H x 8" W
3/4" Depth

WHC85-XS
6-1/4" H x 4-1/4" W
1/2" Depth

WHC85-S
8-3/8" H x 5-1/4" W
5/8" Depth

WHC85-L
15" H x 9-1/2" W
3/4" Depth



WHC58
10" H x 9-3/8" W
1" Depth



WHC83-M
4-1/2" H x 12" W
1" Depth

WHC83-L
6" H x 16" W
1" Depth



WHC67
5-3/4" H x 11" W
1" Depth

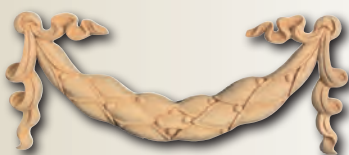

WHC63
5" H x 12" W
3/4" Depth



WHC72
6-1/2" H x 3-3/8" W
3/4" Depth

(Measurements are approximate)

APPLIQUES

These ornaments are made of Medium Density Light Grain White Wood. (Similar to Basswood)



WHC64
7-3/4" H x 7-1/2" W
3/4" Depth



WHC61
8" H x 7-3/8" W
1" Depth



WHC80
9-7/8" H x 8" W
4" Depth

WHC80-S
6-1/4" H x 5" W
3-1/2" Depth

WHC80-L
12" H x 10" W
6" Depth

CORBELS



WHC79
(White Hardwood)
8-1/2" H x 5-1/8" W
3-5/8" Depth



WHC77
(White Hardwood)
9" H x 6-1/2" W
5" Depth



WHC87-M
(White Hardwood)
9" H x 6" W
4" Depth



WHC71
(White Hardwood)
12" H x 10-1/8" W
7-3/4" Depth

WHC71-M
(White Hardwood)
9" H x 8-1/4" W
5-3/4" Depth

WHC71-S
(White Hardwood)
6-1/8" H x 5-5/8" W
3-3/4" Depth

WHC71-L
(White Hardwood)
14" H x 11-3/4" W
8-1/2" Depth



WHC73
(White Hardwood)
12-1/2" H x 6-1/2" W
6-1/4" Depth

WHC73-S
(White Hardwood)
7" H x 4-1/8" W
3-3/4" Depth

WHC73-L
(White Hardwood)
17-1/2" H x 10" W
8" Depth



WHC87-XL
(White Hardwood)
13" H x 3-1/2" W
3-1/2" Depth

(Measurements are approximate)



THE RESIN ARTISAN & COLLECTION

The Resin Artisan Collection is an exquisite line of ornamentation products born of a hybrid technology. Hardwood Maples & Resins are combined to achieve the most intricate & crisp detailing available.

These products are as easy to work with as wood while having several advantages over wood alone. The hybrid technology allows for consistent density without knots, warping or cupping. All standard woodworking tools & glues can be used just as with wood.

The non porous resin absorbs stains evenly, resulting in a beautifully uniform finish & color.

Experience the exquisite detailing & easy to work with material of The Resin Artisan Collection.

- Hybrid Technology
- Consistency of Material & Finish
- Ease of Use
- Unparalleled Detailing
- Over 1300 Castings/Designs
- Endless Applications



CAPITALS



6-130AA-CAP
Height: 4-3/4"
Top: 3-3/4" W x 1-1/4" D
Bottom: 2-1/2" W x 1" D



6-141A-CAP
4-1/4" W x 7-3/4" H x 2-3/4" D
Collar: 3-1/2" W x 1-1/4" D



New

6-134A-CAP
6-1/4" W x 10-3/4" H x 3-3/4" D
Collar: 3-1/4" W x 2-3/4" D

COLUMNS



18-111A-7-COLM
3-1/4" W x 7' H x 1" D



18-112A-7-COLM
3-1/4" W x 7' H x 1" D



New

18-106A-TC-54-COLM
54" Tapered column

BASES



3-116A-BASE
Height: 15-1/4"
Top: 3-1/4" dia.
Bottom: 4-1/4" dia.



3-119B-BASE
Width: 4-1/2"
Height: 16"
Thickness: 2"



New

3-117RA-XT-BASE
Top: 5" W x 3-1/2" D
Bottom: 8-1/4" W x 5" D
Height: 13-1/4"



- A. 51-156C-MLD
- B. 51-213D-MLD
- C. 6-144A-CAP
- D. 6-134A-CAP
- E. 18-106A-TC-74-COLM
- F. 54-421BL-S-OL
- G. 18-130B-5-COLM
- H. 3-106A-BASE
- I. 3-116A-BASE
- J. 3-117A-BASE
- K. 3-200B-BASE
- L. 21-311C-CB

CARTOUCHES

New



9-195B-CT
8-3/4" W x 3-3/4" H x 1" D

9-195C-CT
13-3/4" W x 5-3/4" H x 1-1/2" D



9-196B-CT
6-1/2" W x 3" H x 1/2" D

CENTERS



A. 3-112A-BASE
B. 15-160-CP
C. 6-145A-CAP
D. 18-108A-4-COLM
E. 51-250F-MLD
F. 51-320-MLD
G. 51-125B-MLD



15-130A-CP
6-1/2" W x 8" H x 1" D



15-141-CP
3-1/4" W x 3-1/2" H x 1/2" D

CORNER ELEMENTS



A. 54-165A-OL
B. 18-112B-3-COLM
C. 51-250F-MLD
D. 24-135-CE
E. 3-106AT-BASE



24-131E-CE
22" W x 22" H x 1-1/4" D



24-136-CE
3-3/4" W x 3-3/4" H x 1/2" D

CORBELS



- | | |
|-------------------|----------------|
| A. 51-156C-MLD | G. 54-330B-OL |
| B. 42-120B-FRZ | H. 15-147A-CP |
| C. 6-130C-CAP | I. 21-305B-CB |
| D. 51-110-MLD | J. 45-5-3-KS |
| E. 18-117C-5-COLM | K. 51-185F-MLD |
| F. 15-106B-CP | L. 54-153-OL |



21-103A-CB
2-1/4" W x 3-1/2" H x 1-1/2" D



New

21-220C-CB
9-1/4" H x 2-3/4" D



New

21-311B-CB
4-1/2" W x 17-1/2" H x 2-1/2" D

ONLAYS



- A. 51-110-OL B. 54-140D-OL



54-110-OL
7-3/4" W x 11-1/2" H x 1/2" D

New



54-332D-OL
5-1/2" W x 29" H x 1-1/4" D



54-403-OL
4-1/2" W x 2-1/4" H x 3/4" D

DECOS



27-100-DC
2-1/4" W x 4-1/2" H x 1/2" D

New



27-102-DC
2-1/4" W x 2-1/4" H x 1/2" D

DROPS



30-104-DP
1" W x 7-1/2" H x 1/2" D



30-200AA-DP
1-1/4" W x 10-1/2" H x 1/2" D

FACES



33-113-FACE
3-1/2" W x 4" H x 1-1/4" D



33-120D-FACE
4-1/2" W x 5-3/4" H x 1-3/4" D

FINIALS



39-102-FIN
4-3/4" W x 6" H x 4-3/4" D



39-110-FIN
2-1/4" dia. x 3-3/4" H

FESTOONS



36-101A-FEST
6-1/4" W x 2-1/4" H x 1/2" D
36-101B-FEST
8-1/4" W x 1-1/2" H x 1/2" D

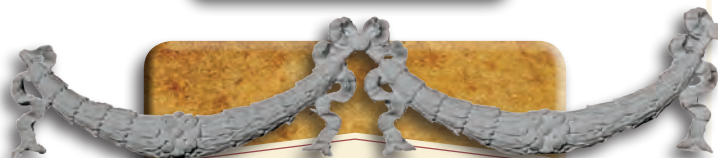

36-103-FEST
15-1/2" W x 3-1/4" H x 1/2" D

A. 51-156TDA-MLD with
51-103A-MLD Insert
B. 84-4-AT-PB

C. 21-331AT-CB
D. 18-115B-8-COLM
E. 9-105AD-CT



All Mouldings Are Flexible Resin

FRIEZES



- A. 6-144A-CAP
- B. 54-421BL-S-OL
- C. 18-130B-5-COLM
- D. 3-106B-BASE
- E. 42-200B-FRZ
- F. 6-134A-CAP
- G. 18-106A-TC-54-COLM



42-103-FRZ
2-1/2" W x 1/2" D x 8' L x 3" repeat



42-155A-10-FRZ
4" W x 10' L x 4" RPT repeat

All Mouldings Are Flexible Resin

MOULDINGS



A. 51-151FF-MLD



51-105A-MLD
5/8" W x 3/8" D x 10' L repeat

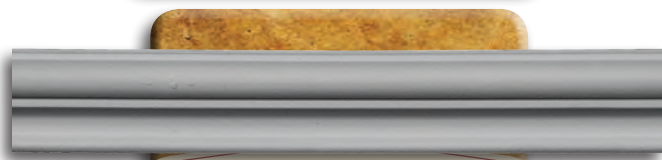

51-174-MLD
1-3/4" W x 1" D x 10' L

MEDALLIONS

A. 48-106CTR-A-MD
with 48-106CTR-B-MD



48-100-MD
12-1/2" dia x 5" D



48-103-MD
10-1/2" dia x 2-1/4" D

THE RESIN ARTISAN COLLECTION

SWAGS



78-106A-EXT-SW
3-3/4" W x 9" H x 1/2" D each side
78-106B-EXT-SW
4-3/4" W x 12" H x 1/2" D each side
78-106C-EXT-SW
6-1/4" W x 14-1/2" H x 1/2" D each side



78-125A-SW
5" W x 2" H x 3/4" D each side
78-125B-SW
10" W x 3" H x 3/4" D each side
78-125C-SW
18" W x 5" H x 1-1/4" D each side

SCROLLS

New



75-300AA-SPC
2" W x 3" H x 1/2" D each side

New



75-301AA-SPC
2" W x 3" H x 1/2" D each side

SPECIALTIES

New



6-200AA-CAP
3" W x 4" H x 1-1/2" D



A. 45-102A-XT-KS D. 3-120A-BASE
B. 51-182F-MLD E. 42-200A-FRZ
C. 18-107B-4-COLM

PLINTH BLOCKS



A. 42-155C-6-FRZ
 B. 42-153C-6-FRZ
 C. 60-293-PB
 D. 18-115B-8-COLM
 E. 54-210-OL



60-3-2-PB
 3-1/4" W x 3-1/4" H x 1-3/4" D

New



60-3-3-PB
 3-1/4" W x 3-1/4" H x 1-3/4" D

PULLS



A. 63-109-PULL



63-111-D-PULL
 2-1/2" W x 3" H x 1-1/4" D



63-111B-PULL
 6-1/2" W x 3" H x 1-1/4" D

RINGS

A. 66-123B-RING



New



66-105-RING
 6-1/4" O.D. 3/4" I.D.
 1/2" thick



66-123B-RING
 8-7/8" O.D. 5" I.D.
 1" thick

PANELS



A. 57-103B-PANEL
B. 21-221F-CB
C. 18-115D-5-COLM



57-103A-PANEL
8" W x 17-1/4" H x 1" D
57-103B-PANEL
12-3/4" W x 22-3/4" H x 1-1/4" D

New



57-150L-PANEL
9-1/4" W x 20-3/4" H x 1/2" D



57-129-PANEL
29-1/4" L x 2-3/4" H x 1-3/4" D

KEYSTONES

A. 51-185F-MLD (Flex) D. 51-204B-MLD
B. 45-107C-KS E. 3-118C-BASE
C. 51-185-MLD (Wood)



45-102A-XT-KS
12" W x 6-3/4" H x 2-1/2" D

New



45-105A-XT-KS
16-3/4" W x 7-3/4" H x 3" D



45-107A-KS
21-3/4" x 6-3/4" x 2-3/4"

ROSETTES



A. 69-357C-ROST
B. 6-130B-CAP



69-123-ROST
1-1/2" dia. x 1/2" D



69-166-ROST
2-1/2" dia. x 1-1/4" D



69-351A-ROST
4" dia. x 3/4"

SCONCES



A. 72-102-SCON



72-100-SCON
12" W x 9" H x 7" D



72-101-SCON
10-1/4" W x 14-1/2" H x 7" D



72-102-SCON
8" W x 10" H x 4" D

CEILING ELEMENTS



A. 12-122-CEIL

New



12-122-CEIL
16-1/2" W x 16-1/2" H x 3-1/2" D



12-130-CEIL
27" W x 27" H x 6" D

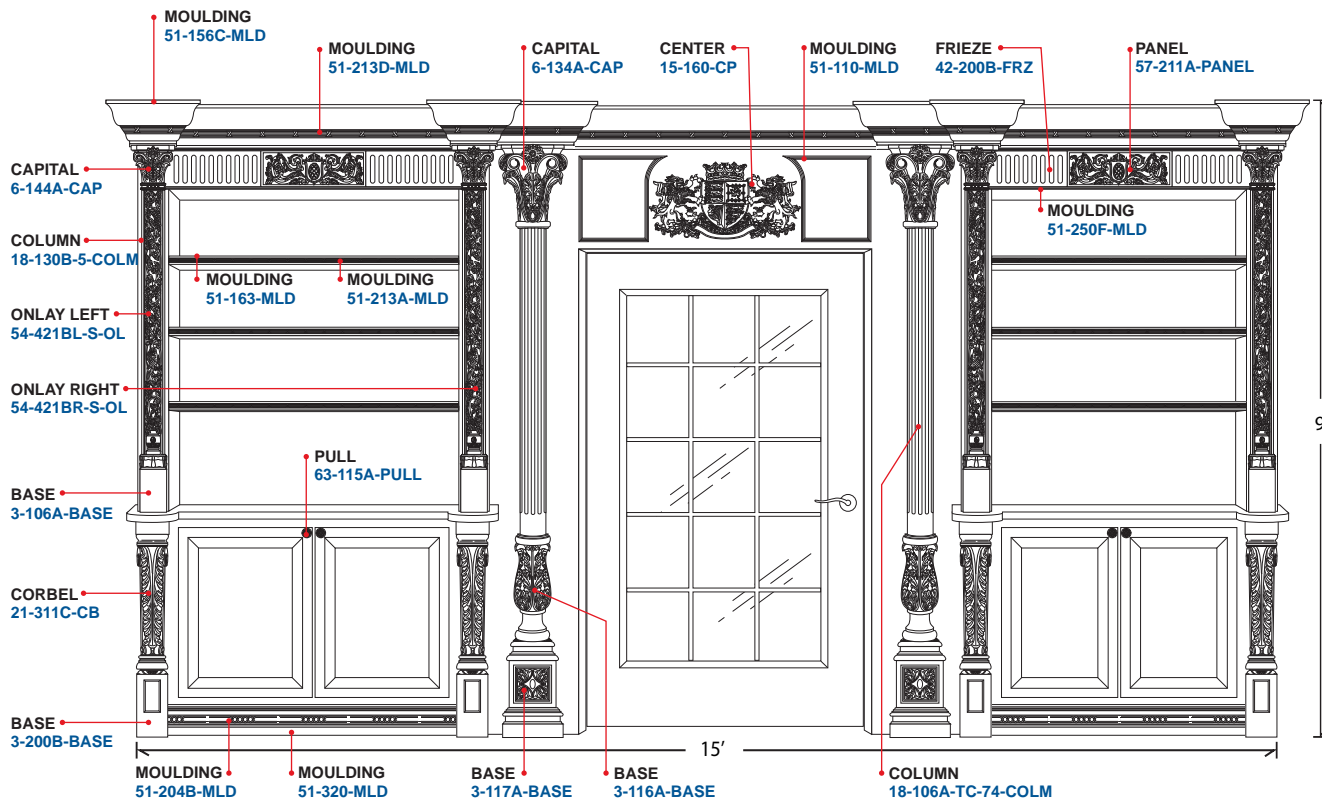

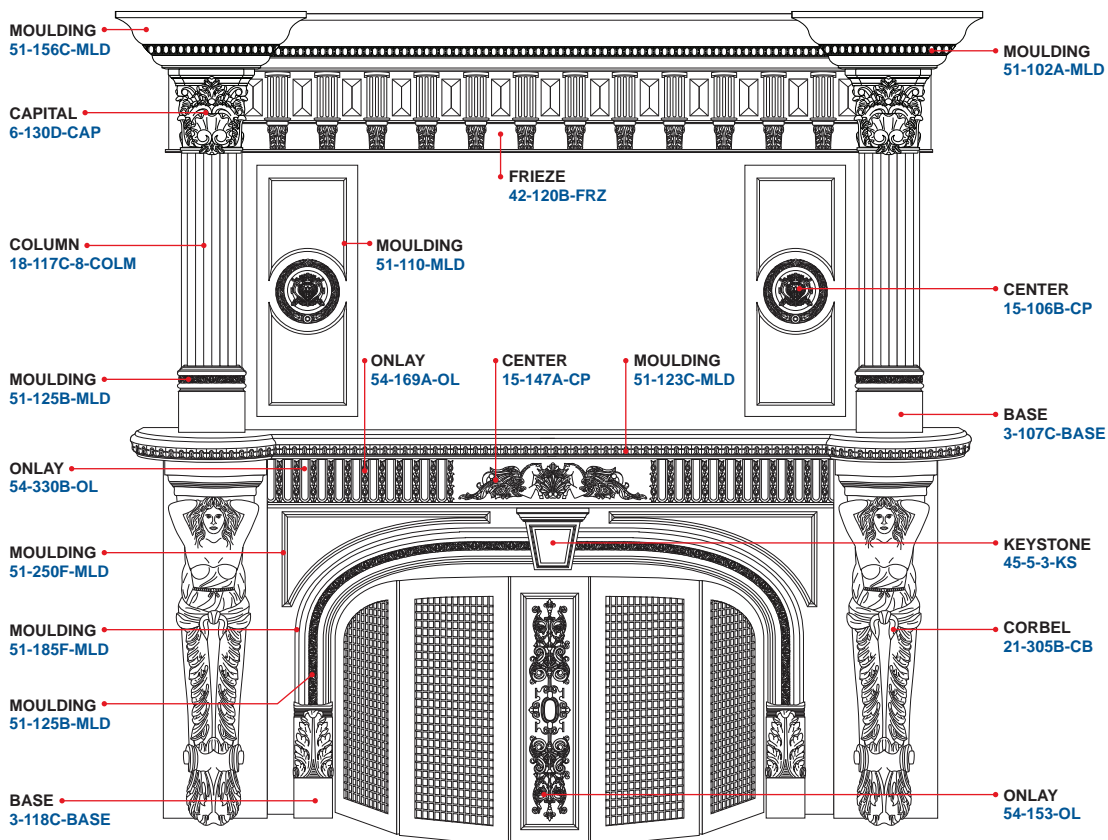

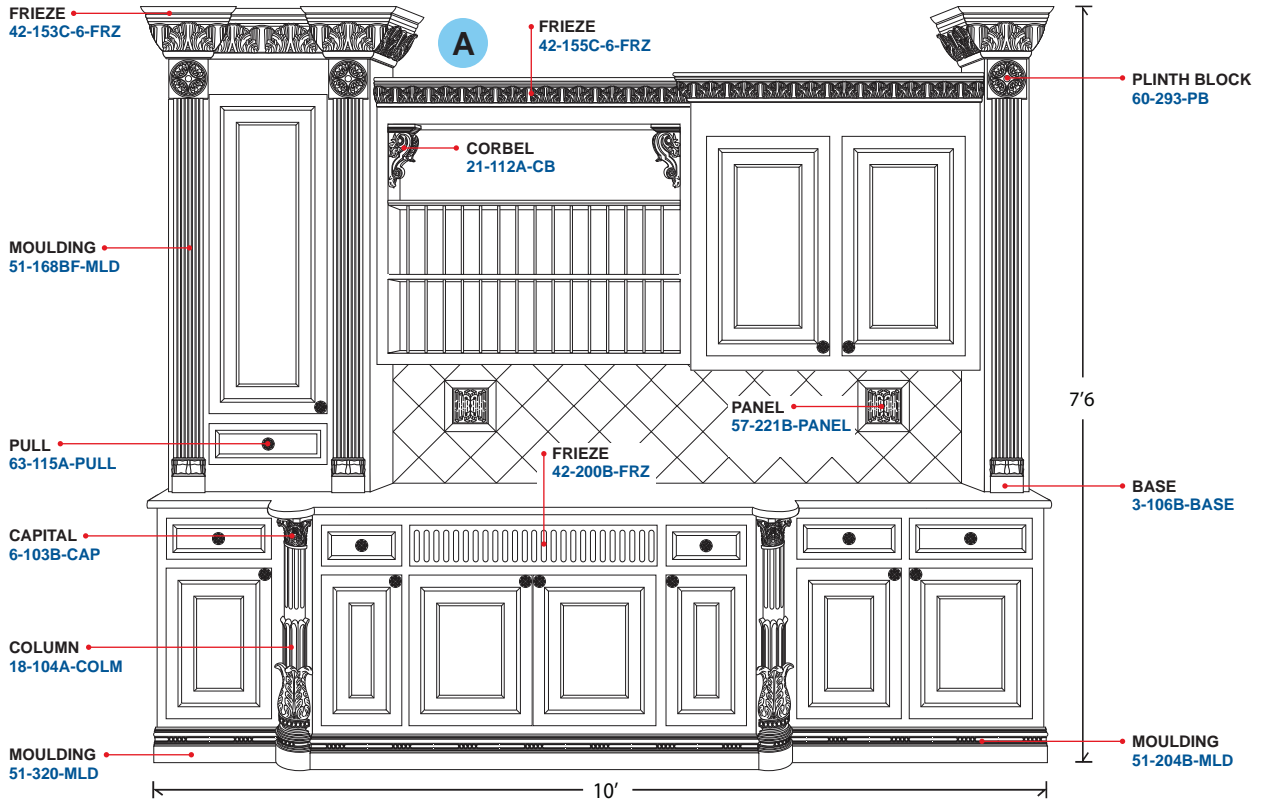

THE RESIN ARTISAN COLLECTION

New

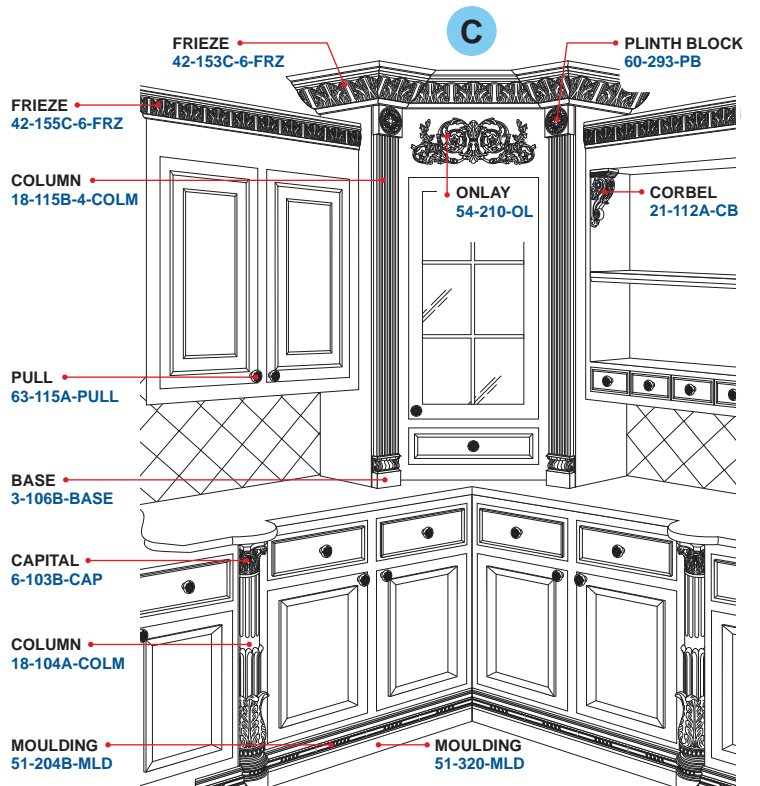
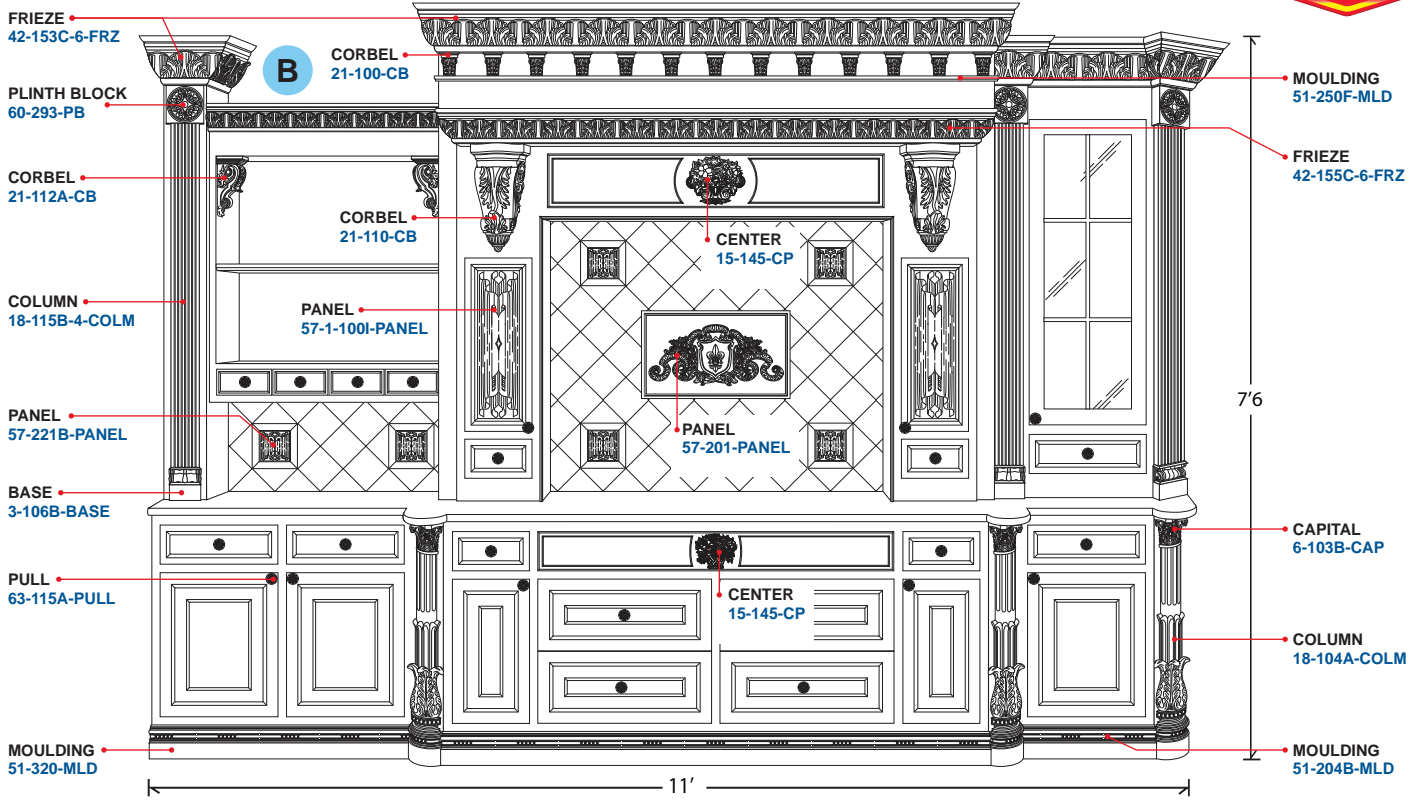

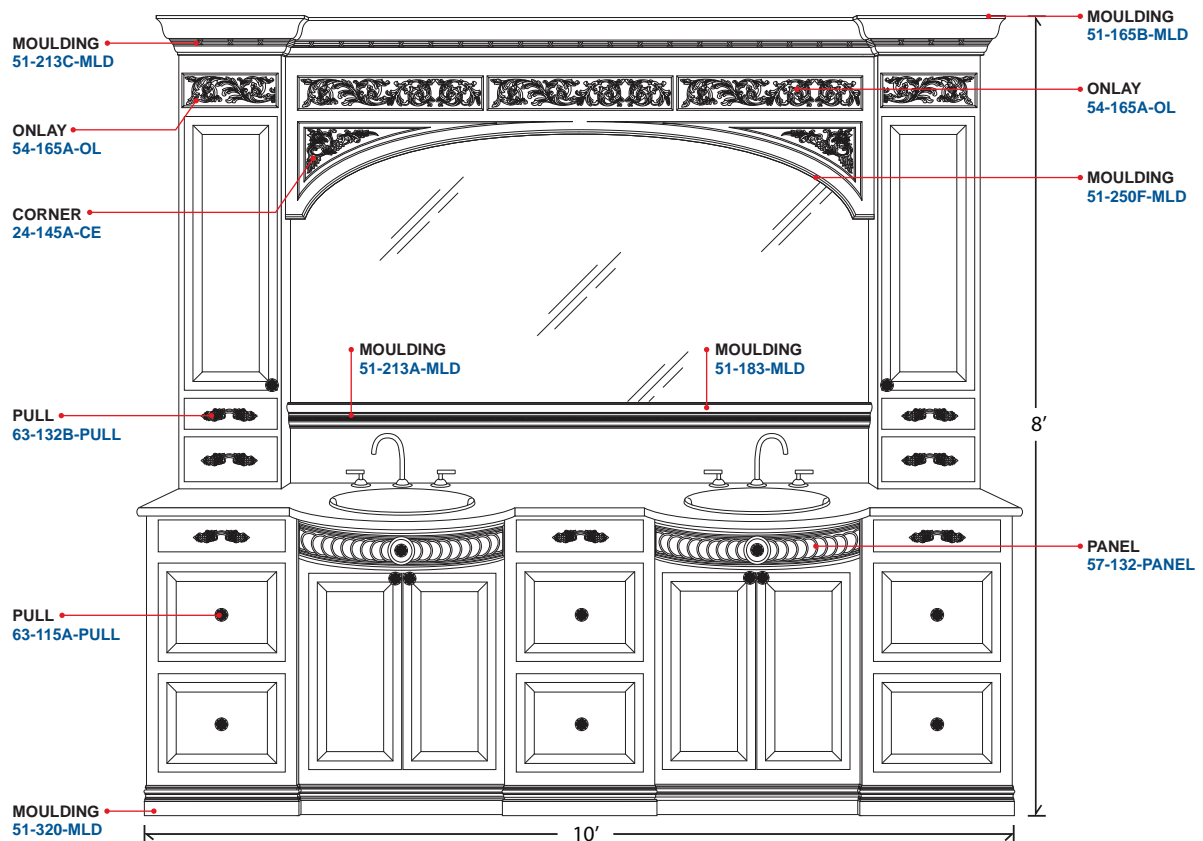

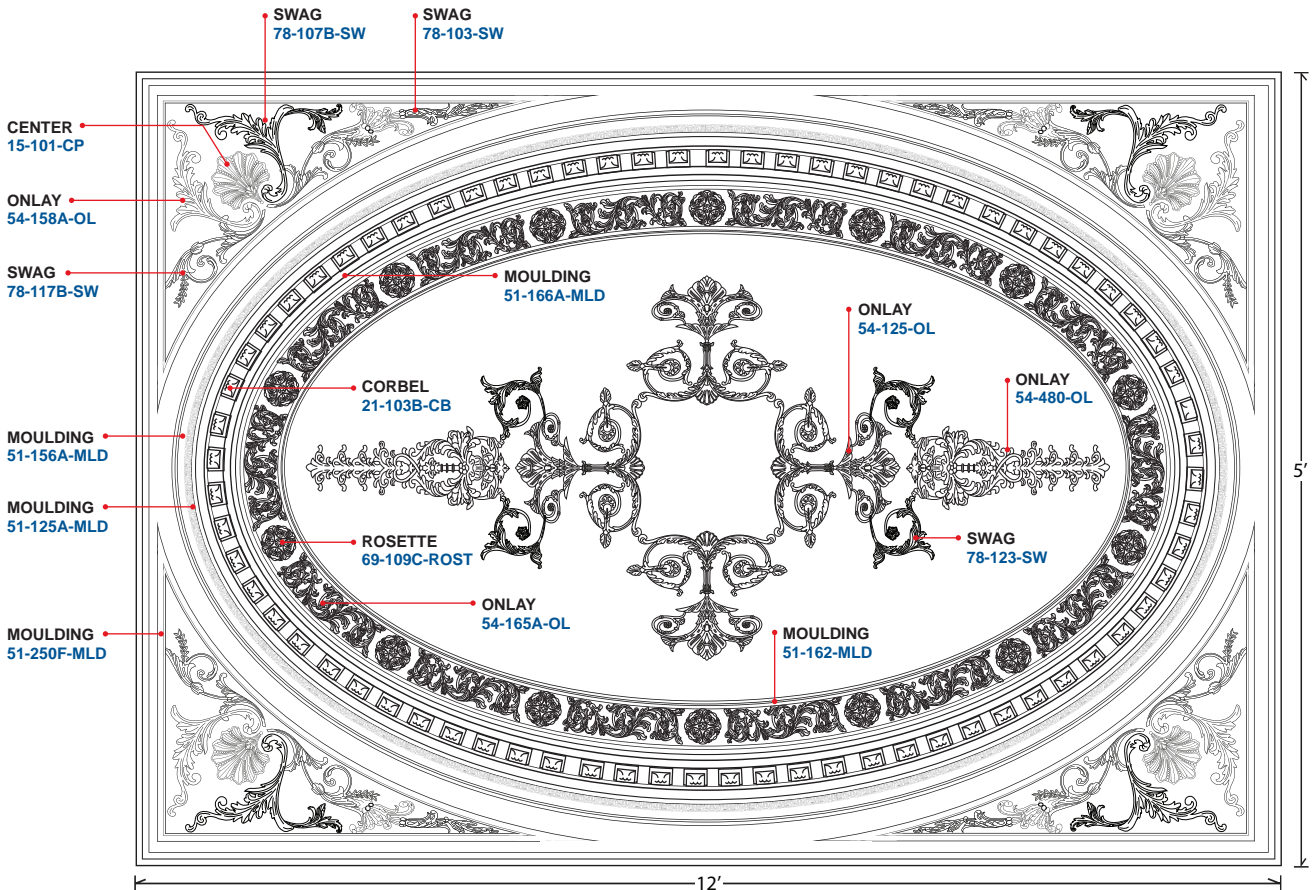

CAPITALS

These ornaments are made of a Polymer Resin material. This is the true base finish shown "swatch".

Due to photographic imaging, products can vary in color.

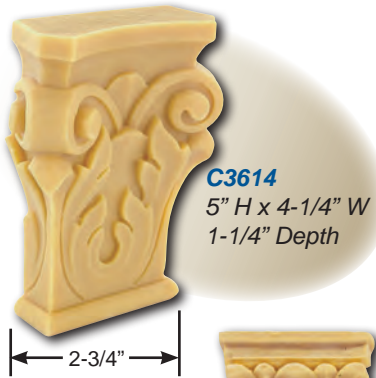

C3614
5" H x 4-1/4" W
1-1/4" Depth

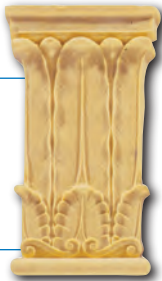

* **C1001**
5-3/4" H x
3-1/4" W
7/8" Depth



C3505-A
5-7/8" H x 4-1/8" W
1-3/4" Depth



Shown : C3505-A



C3615
6-3/4" H x 4" W
1" Depth

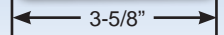

* Supplied with pre-attached keyhole hangers



C1044
3" H x 3-1/8" W
1-1/4" Depth

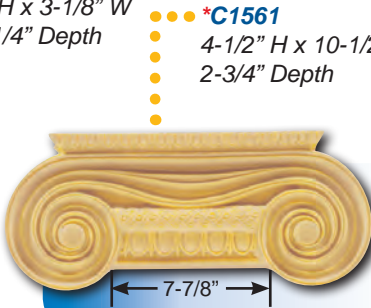
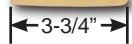

* **C1561**
4-1/2" H x 10-1/2" W
2-3/4" Depth

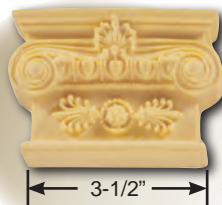
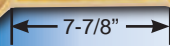

C1147
3" H x 4-1/8" W
1" Depth

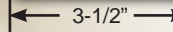

* **C1122**
6" H x 7-1/8" W
3-5/8" Depth

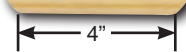
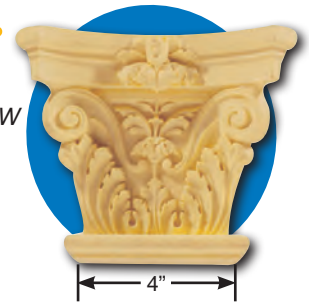

BASES



Shown : A3501



A3501
32-1/2" H x
4-1/8" W
1-3/4" Depth

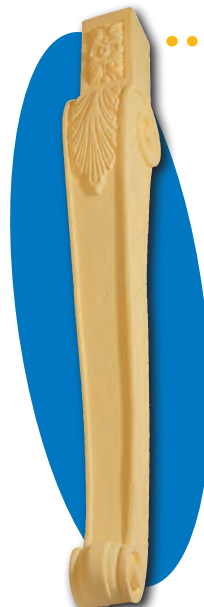

A4201
29" H x 3-3/8" W
4-1/2" Depth



A1121
19" H x 4" W
7-7/8" Depth

(Measurements are approximate)

CORBELS

These ornaments are made of a Polymer Resin material. This is the true base finish shown "swatch".

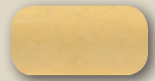

Due to photographic imaging, products can vary in color.



***C1002**
4-3/8" H x 3" W
1-1/4" Depth

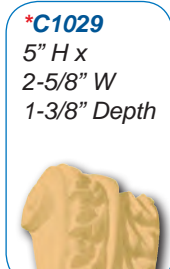

***C1029**
5" H x
2-5/8" W
1-3/8" Depth



***C1014**
8-3/4" H x
3-3/4" W
3-3/4" Depth



***C4044**
14-3/4" H x 5" W
5" Depth



***C1516**
9" H x 5-1/4" W
4-3/4" Depth



***C1573**
11-3/4" H x 4-3/4" W
5-1/2" Depth



***C1540**
11-7/8" H x 6-7/8" W
6-1/8" Depth



***C1539**
23" H x 7-3/4" W
7-1/4" Depth

FOR THIS DESIGN IN MORE SIZES, SEE PAGE 426.

** Supplied with pre-attached keyhole hangers*

CENTERS



A1217
12-3/4" H x 8-1/8" W
3/4" Depth

***A1218**
11" H x 14-7/8" W
1-3/8" Depth



CARTOUCHES

***D1387**
14-3/4" H x 44" W
1-1/4" Depth



(Measurements are approximate)

DECOS

D9006
17" Dia.
3/4" Depth



A2355
22-1/2" H x 6" W
1-1/2" Depth



A1006
5-3/8" H x 9-1/2" W
1" Depth



A1008
7-1/2" H x 4-1/4" W
1" Depth



These ornaments are made of a Polymer Resin material. This is the true base finish shown "swatch".

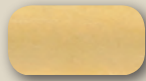

Due to photographic imaging, products can vary in color.

FESTOONS



A1564
(3 Piece Set)
6-1/2" H x 18-3/8" W
1/2" Depth

A1567
(Bow)
8-1/2" H x 5" W
3/4" Depth

A1566
(2 Piece Set)
17-1/2" Long x 23" Wide x 3/4" Depth

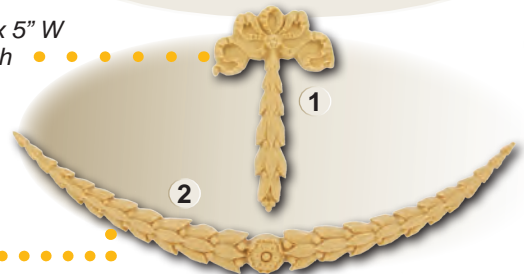

A1565
(Swag)
17-1/2" Long
3/4" Depth

ROSETTES

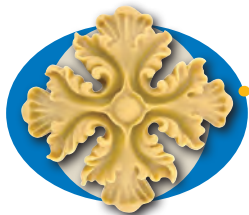

A3412
5" H x 5" W
1-1/4" Depth



***A3202**
6-1/4" H x 6-1/4" W
1-1/2" Depth

***A3203**
6-1/4" H x 6-1/4" W
1-1/2" Depth



SCROLLS

SOLD AS A LEFT & RIGHT PAIR (dimensions are for one side only)

A1315
Pair of Leaf Overlays
10-1/2" H x 24-3/4" W x 1-1/2" Depth

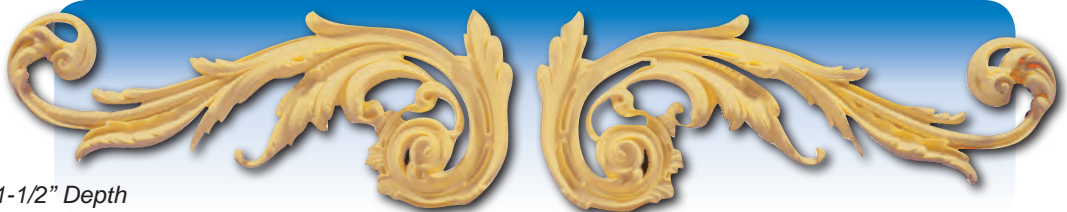

(Measurements are approximate)

APPLIQUES

These ornaments are made of a **Laminated Wood** with a **Maple Veneered Surface**. Detail is pressed in.



RWA20-M
1-3/16" Dia.
3/16" Depth



RWA21-M
1-9/16" Dia.
3/16" Depth



RWA22-M
2-1/2" Dia.
3/16" Depth



RWA24-M
3-1/2" Dia.
3/16" Depth

CC632

1-3/8" Dia.
1/4" Depth



CC634

1-1/2" Dia.
1/4" Depth



RWA25-M
2" Dia.
3/16" Depth



RWA27-M
2-3/8" Dia.
3/16" Depth



RWA28-M
2-9/16" Dia.
1/4" Depth



CC677
3" Dia.
1/4" Depth

CC601

3-3/4" Dia.
1/4" Depth



CC609

5-1/8" Dia.
1/4" Depth



RWA57-M

4-3/8" H x 5" W
3/16" Depth



RWA26-M
2-3/4" H x 1-3/8" W
3/16" Depth



RWA29-M
3-11/16" H x 1-7/8" W
3/16" Depth



RWA51-M
3" H x 5-3/4" W
1/4" Depth

CC635

1-3/4" Dia.
1/4" Depth



RWA47-M

2-3/16" H x 3" W
3/16" Depth



RWA46-M

2-13/16" H x 1-1/2" W
1/4" Depth



(Measurements are approximate)

APPLIQUES

These ornaments are made of a **Laminated Wood** with a **Maple Veneered Surface**. Detail is pressed in.



RWA48-M
3-5/16" H x
3-5/16" W
1/4" Depth



RWA50-M
5" H x 5" W
3/16" Depth



CC607
4" H x 3-3/4" W
1/4" Depth

CC687

5-3/4" H x 4" W
1/4" Depth



RWA52-M

3-11/16" H x 2-11/16" W
3/16" Depth



CC693

4-1/2" H x 4-1/2" W
1/4" Depth



CC606
2-1/2" H x 3-3/8" W
1/4" Depth



CC604
4" H x 3-3/8" W
1/4" Depth



CC640
2-3/4" H x 1" W
1/4" Depth



CC676
2-1/4" H x 1-7/8" W
1/4" Depth

RWA45-M

4-3/8" H x 6" W
3/16" Depth



RWA41-M
2-1/2" H x 3" W
3/16" Depth

RWA42-M

2-1/2" H x 5-3/4" W
3/16" Depth



RWA34-M
4-1/2" H x 9" W x 1/4" Depth



RWS36-M
1-5/8" H x 8-3/8" W x 3/16" Depth



RWS38-M
2-5/8" H x 9-1/4" W x 1/4" Depth

(Measurements are approximate)

APPLIQUES

These ornaments are made of a **Laminated Wood** with a **Maple Veneered Surface**. Detail is pressed in.



RWS47-M
3-1/2" H x 17-3/16" W x 1/4" Depth



RWS45-M
3-5/8" H x 10-13/16" W x 3/16" Depth

RWS50-M

4-3/8" H x 19-3/16" W x 1/4" Depth



RWS37-M
4-1/4" H x 10-1/8" W x 3/16" Depth



CC789
3-3/4" H x 16-1/4" W x 1/4" Depth



CC727
5-5/8" H x 36-7/8" W x 1/4" Depth

CC729
7" H x 41" W x 1/4" Depth



SCROLLS

SOLD AS A LEFT & RIGHT PAIR (dimensions are for one side only)

These ornaments are made of a **Laminated Wood** with a **Maple Veneered Surface**. Detail is pressed in.



RWS26-M
6" H x 3-3/8" W
3/16" Depth

RWS29-M
10-5/8" H x 2-3/4" W
1/4" Depth

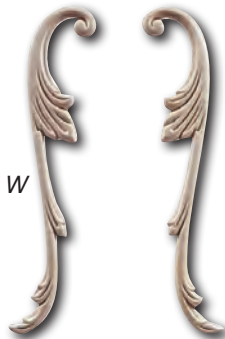

RWS22-M
5-3/8" H x 2-3/8" W
3/16" Depth

RWS28-M
9-11/16" H x 3-3/8" W
1/4" Depth



CC605
1-3/8" H x 3-1/8" W x 1/4" Depth



CC665
5-3/4" H x 11-1/4" W x 1/4" Depth



CC776
2-3/8" H x 14-1/2" W x 1/4" Depth

(Measurements are approximate)

CARTOUCHES

These **DECORATIVE** Textured Woodgrain ornaments are made of a **Lightweight Polymer**.

Some ornaments have been finished for photographic purposes-ornaments come unfinished only.



APP-59
3-5/16" H x 7-1/2" W
9/16" Depth



APP-55
4-1/16" H x 14-5/16" W
1/2" Depth



APP-50
4-3/4" H x 14-13/16" W
3/8" Depth



APP-85
5-13/16" H x 15-1/2" W
9/16" Depth



APP-72
6-7/8" H x 15-3/4" W
5/8" Depth



APP-73
7-1/4" H x 15-3/4" W
1-1/16" Depth



APP-70
9-1/16" H x 17-1/8" W
1-3/16" Depth



APP-74
4-1/2" H x 19-11/16" W
9/16" Depth



APP-80
3" H x 20-1/4" W
9/16" Depth



APP-69
8-13/16" H x 22-7/16" W
1-3/16" Depth



APP-78
4-3/4" H x 24-3/16" W
9/16" Depth

(Measurements are approximate)

USE GEL STAIN OR PAINT TO FINISH PRODUCT

SCROLLS

These **DECORATIVE Textured Woodgrain** ornaments are made of a **Lightweight Polymer**.

Some ornaments have been finished for photographic purposes-ornaments come unfinished only.



APP-10
3-3/8" H x 7-3/4" W
9/16" Depth each side

APP-18
6-11/16" H x 2" W
9/16" Depth each side

APP-12
4-7/16" H x 4-13/16" W
1/2" Depth each side



APP-11
3-5/16" H x 7-13/16" W
9/16" Depth each side

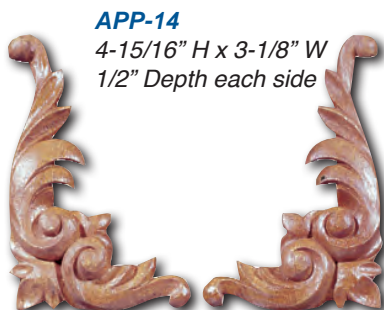

APP-14
4-15/16" H x 3-1/8" W
1/2" Depth each side

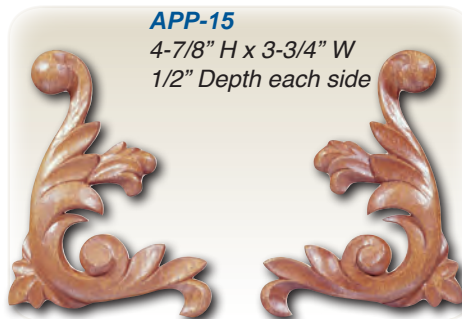

APP-15
4-7/8" H x 3-3/4" W
1/2" Depth each side



APP-19
11-5/8" H x 5-5/16" W
5/8" Depth each side

CORBELS



APP-33
3-1/2" H x 2-3/8" W
1-9/16" Depth



BKT4X8S
Woodgrain/Stainable
Oak Texture
7-5/8" H x 3-1/4" W
3-7/8" Depth



APP-32
9-1/16" H x 4-3/4" W
2-3/4" Depth

CAPITALS



6-1/2"

APP-131
5-5/16" H x 8-7/8" W
2-3/16" Depth

(Measurements are approximate)

USE GEL STAIN OR PAINT TO FINISH PRODUCT

ONLAYS

These **DECORATIVE** Textured Woodgrain ornaments are made of a **Lightweight Polymer**.

Some ornaments have been finished for photographic purposes-ornaments come unfinished only.



APP-112
2-3/4" H x 13/16" W
3/8" Depth



APP-111
3-1/4" H x 1-1/16" W
3/8" Depth



APP-110
4-1/8" H x 1-5/8" W
1/2" Depth



APP-98
3-1/8" H x 2" W
9/16" Depth



APP-66
2" H x 3-1/2" W
3/8" Depth



APP-67
2-1/4" H x 4-5/16" W
1/2" Depth



APP-63
3-1/4" H x 6-1/2" W
9/16" Depth



APP-61
3-9/16" H x 7-5/8" W
9/16" Depth



APP-64
2" H x 8" W
1/2" Depth



APP-68
3-15/16" H x 9-7/16" W
1/2" Depth



APP-52
6-5/16" H x 9-3/4" W
1/2" Depth



APP-86
4-5/16" H x 11-13/16" W
9/16" Depth



APP-89
2-1/2" H x 12" W
1/2" Depth



APP-71
7-1/16" H x 15-9/16" W
9/16" Depth



APP-113
10-5/16" OD x 6-7/16" ID
9/16" Depth



APP-114
14-3/8" H x
14-3/16" W
9/16" Depth

APP-81
3-5/8" H x 15-7/16" W
9/16" Depth



APP-76
7-11/16" H x 17-15/16" W
9/16" Depth

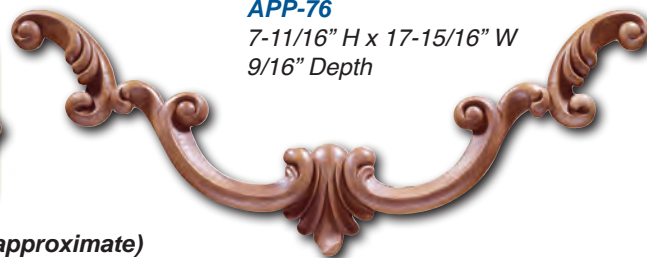

(Measurements are approximate)

USE GEL STAIN OR PAINT TO FINISH PRODUCT

ONLAYS

These **DECORATIVE Textured Woodgrain** ornaments are made of a **Lightweight Polymer**.

Some ornaments have been finished for photographic purposes-ornaments come unfinished only.



APP-84
1-3/8" H x 9-5/16" W
3/4" Depth



APP-62
1-3/4" H x 10-5/16" W
1/2" Depth



APP-88
1-3/4" H x 14" W
3/4" Depth



APP-79
2" H x 19-11/16" W
3/4" Depth



APP-118
1-9/16" H x 19-11/16" W
3/4" Depth



APP-77
4-5/16" H x 24" W
9/16" Depth

PANELS



APP-40
7-1/2" H x 22-1/16" W
3/4" Depth



APP-41
10" H x 19-1/4" W
3/4" Depth

(Measurements are approximate)

USE GEL STAIN OR PAINT TO FINISH PRODUCT

ROSETTES

These **DECORATIVE** Textured Woodgrain ornaments are made of a **Lightweight Polymer**.

Some ornaments have been finished for photographic purposes-ornaments come unfinished only.



APP-92
3-3/8" H x 3-3/8" W
9/16" Depth



APP-91
3-15/16" Dia.
1/2" Depth



APP-93
3-15/16" H x 3-15/16" W
1/2" Depth



APP-96
4-1/8" H x 4-1/8" W
5/8" Depth



APP-94
4-11/16" H x 4-11/16" W
5/8" Depth



APP-95
2-7/16" H x 4-3/8" W
5/8" Depth



APP-90
3-1/8" H x 5-1/16" W
1/2" Depth



APP-99
2-9/16" H x 5-1/8" W
5/8" Depth



APP-100
4-1/8" H x 6-5/8" W
3/4" Depth

CENTERS



APP-120
6-5/16" H x 4-1/4" W
3/4" Depth



APP-116
9-5/8" H x 5-1/8" W
11/16" Depth



APP-117
9-7/16" H x 7-7/8" W
9/16" Depth



APP-119
11-3/4" H x 5-7/8" W
11/16" Depth

APP-53
4-15/16" H x 12-3/16" W
9/16" Depth



APP-56
3-1/4" H x 9-9/16" W
9/16" Depth



APP-115
19-7/8" H x 9-7/16" W
1-1/16" Depth

(Measurements are approximate)

USE GEL STAIN OR PAINT TO FINISH PRODUCT

POLYURETHANE NON-TEXTURED ORNAMENTS

CEILING & WALL SMOOTH APPLIQUES

Manufactured of high density polyurethane, these plaster-like decorative ornaments are lightweight, primed and ready to paint.

DSA-103

3-3/8" Dia.
3/4" Depth



DSA-109

5" Dia.
3/4" Depth

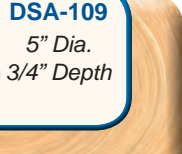

DSA-107

4" Dia.
3/4" Depth



DSA-125

3-1/2" H x 5" W
3/4" Depth



DSA-123

4-3/4" H x
3-1/4" W
1/2" Depth



DSA-152

6" H x 12-1/4" W
3/4" Depth



DSA-130

6-1/2" H x 5" W
1-1/4" Depth



DSA-132

6-1/2" H x 6-1/2" W
7/8" Depth



DSA-134

6-3/4" H x 5-1/2" W
5/8" Depth



DSA-143

9-1/8" H x 6-1/2" W
1" Depth



DSA-425

6-1/2" H x 19" W
1-1/4" Depth



DSA-150

10-3/4" H x 12" W
1-1/4" Depth



DSA-154

12-1/4" H x 9" W
1-1/4" Depth



DSA-157

13" H x 5-1/4" W
1" Depth



DSA-159

13" H x 8-1/2" W
1-1/4" Depth



POLYURETHANE NON-TEXTURED ORNAMENTS

CEILING & WALL SMOOTH APPLIQUES & SCROLLS
Manufactured of high density polyurethane, these plaster-like decorative ornaments are lightweight, primed and ready to paint.

Appliques



DSA-140

3-1/8" H x 8-5/8" W
1" Depth



DSA-146

5-1/4" H x 10-1/2" W
1-1/2" Depth

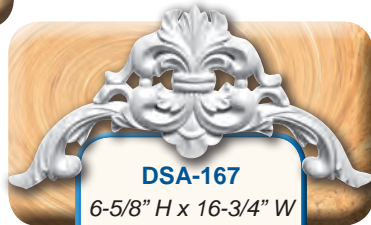

DSA-167

6-5/8" H x 16-3/4" W
7/8" Depth

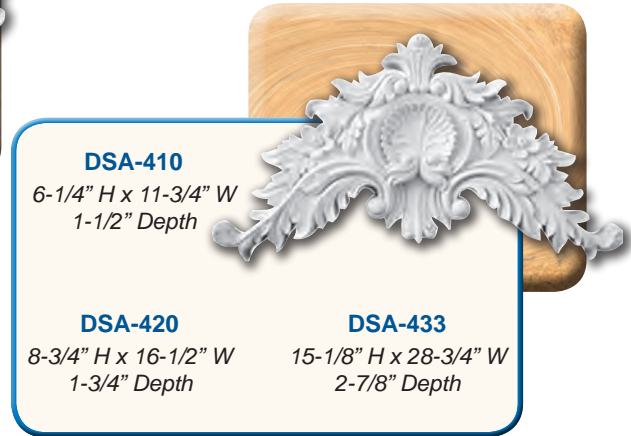

DSA-410

6-1/4" H x 11-3/4" W
1-1/2" Depth

DSA-420

8-3/4" H x 16-1/2" W
1-3/4" Depth

DSA-433

15-1/8" H x 28-3/4" W
2-7/8" Depth

Scrolls

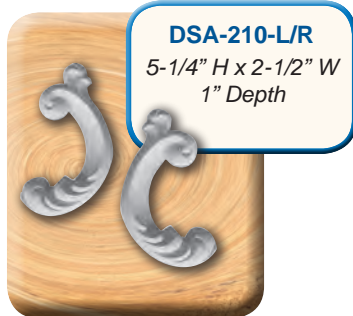

DSA-210-L/R

5-1/4" H x 2-1/2" W
1" Depth



DSA-225-L/R

7-1/4" H x 5" W
1" Depth



DSA-220-L/R

8-1/2" H x 4" W
1" Depth

DSA-230-L/R

11-1/4" H x 5-1/2" W
1-1/8" Depth

DSA-240-L/R

12-1/2" H x 7" W
1-7/8" Depth

DSA-235-L/R

18" H x 7-1/4" W
1-1/2" Depth

POLYURETHANE NON-TEXTURED ORNAMENTS

CEILING & WALL SMOOTH MASSIVE APPLIQUES - Wallscape Series
Manufactured of high density polyurethane, these plaster-like decorative ornaments are lightweight, primed and ready to paint.



DSA-430
9-3/4" H x 28-1/2" W
2-3/4" Depth



DSA-435
12-1/4" H x 32" W
2" Depth



DSA-161
13" H x 10-1/4" W
2-1/4" Depth



DSA-437
14" H x 32" W
2-1/2" Depth



DSA-428
28" H x 25" W
2-1/2" Depth

DSA-439
5-3/4" H x 34-3/4" W
1-1/2" Depth



DSA-448
9-1/2" H x 46-1/2" W
1-1/4" Depth



DSA-445
7-1/4" H x 43-1/2" W
1-1/2" Depth



DSA-450
6-1/2" H x 48" W
2-1/4" Depth



POLYURETHANE NON-TEXTURED ORNAMENTS

SMOOTH CEILING ORNAMENTS

Manufactured of high density polyurethane, these plaster-like decorative ornaments are lightweight, primed and ready to paint.



DSA-109
5" Dia.
3/4" Depth

SHOWN:
DSA-165, DSA-167



DSA-167
6-5/8" H x 16-3/4" W
7/8" Depth



DSA-165
10" H x 16" W
5/8" Depth

DSA-159
13" H x 8-1/2" W
1-1/4" Depth



DSA-154
12-1/4" H x 9" W
1-1/4" Depth



SHOWN:
DSA-154,
DSA-159,
DSA-109



Ceiling Corner

DSA-170
18-1/4" H x 18-1/4" W
2-1/4" Depth

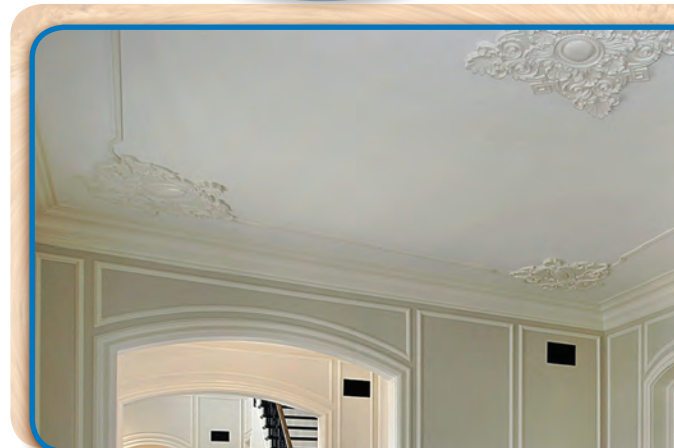

CORBELS

These DECORATIVE high density Smooth Corbels are lightweight, primed and ready to paint.

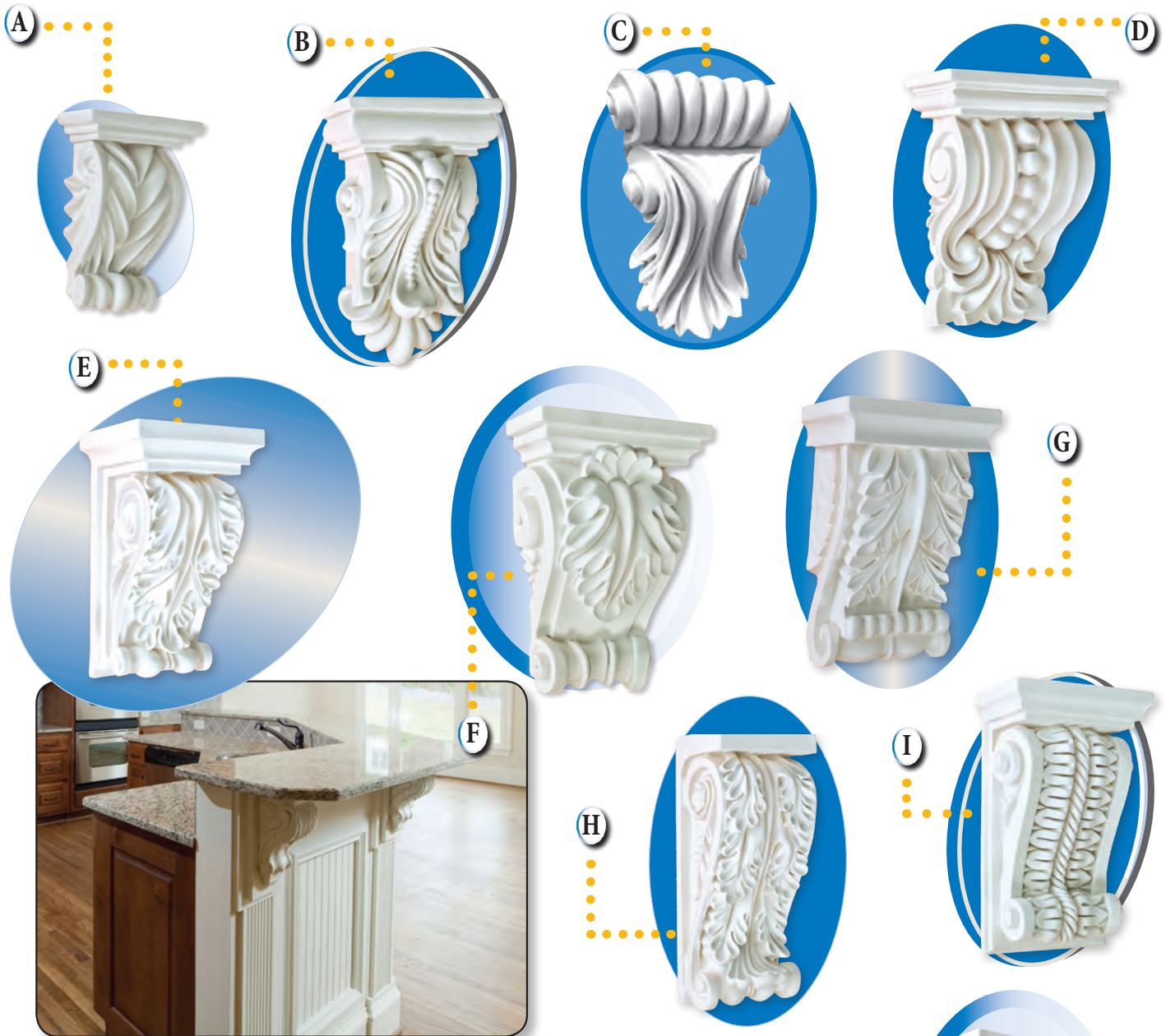

	PART #	HEIGHT	WIDTH	DEPTH	KEYHOLE
A	DCOR-05-XS	3-13/16"	2-9/16"	1-1/2"	No
B	DCOR-07-XS	4-1/2"	3"	1-3/4"	No
C	DCOR-12-XS	5-1/2"	4"	2"	No
D	DCOR-15-XS	5-3/4"	4-1/8"	2-1/4"	No
E	DCOR-20-XS	5-3/4"	3-7/16"	2-3/4"	No
F	DCOR-23-XS	6-1/2"	4-5/16"	2-1/4"	No
G	DCOR-25-XS	6-3/8"	4-3/8"	2-11/16"	Yes
H	DCOR-30-XS	7-7/8"	3-1/4"	2-1/2"	No
I	DCOR-35-S	7-3/4"	4-7/8"	2-3/8"	Yes
J	DCOR-38-S	8-1/4"	5-3/16"	3-1/4"	Yes

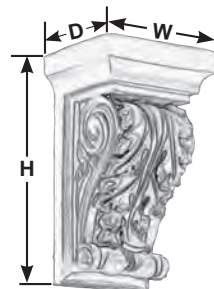

CORBELS

These DECORATIVE high density Smooth Corbels are lightweight, primed and ready to paint.

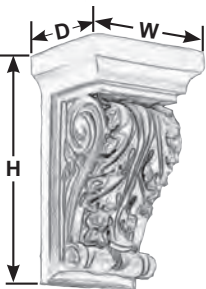

	PART #	HEIGHT	WIDTH	DEPTH	KEYHOLE
K	DCOR-40-S	8-1/8"	4-7/8"	3-7/16"	Yes
L	DCOR-45-S	9-3/8"	6-3/16"	4-5/8"	Yes
M	DCOR-55-S	9-1/2"	4-13/16"	2-1/2"	Yes
N	DCOR-61-M	11"	7-13/16"	3-3/4"	Yes
O	DCOR-65-M	12-1/8"	5-1/8"	5-5/16"	Yes
P	DCOR-80-L	14-5/8"	8-1/4"	4-11/16"	Yes
Q	DCOR-86-L	17-3/8"	5-13/16"	4-1/8"	No
R	DCOR-91-XL	26-7/8"	5"	5"	No
S	DCOR-95-XL	41-1/2"	8-1/8"	7-1/4"	No

DCOR-95-XL

SOLID NORTH AMERICAN HARDWOOD

North American Hard Maple, Red Oak, Cherry or Hardwood (Paint Grade).

LARGE 5" DIAMETER

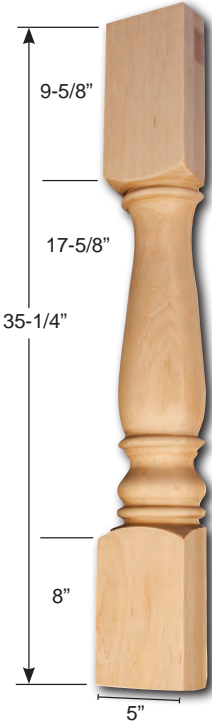

HALF ROUND
(Flush Mount)

- 2-3/8" PROJECTION
ISL-H-55-M-5
- ISL-H-55-OAK-5
- ISL-H-55-CH-5
- ISL-H-55-HW-5



ACANTHUS LEAF

- ISL-60-M-5
- ISL-60-OAK-5
- ISL-60-CH-5
- ISL-60-HW-5



GRAPE

- ISL-65-M-5
- ISL-65-OAK-5
- ISL-65-CH-5



HERRINGBONE COLLECTION

- ISL-70-M-5
- ISL-70-OAK-5
- ISL-70-CH-5



OPEN WEAVE

- ISL-90-M-5
- ISL-90-OAK-5
- ISL-90-CH-5

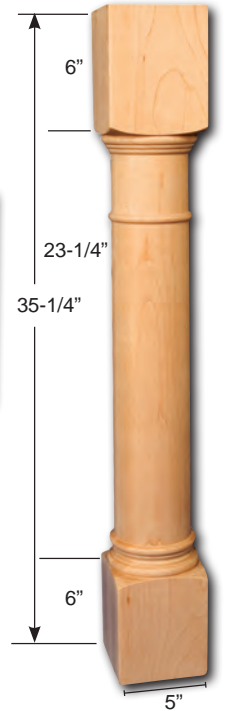

COLUMN

- ISL-75-M-5
- ISL-75-OAK-5
- ISL-75-CH-5
- ISL-75-HW-5

For more Legs, see pages 254-262.

SOLID NORTH AMERICAN HARDWOOD

North American Hard Maple, Red Oak, Cherry or Hardwood (Paint Grade).

LARGE 5" DIAMETER



ROPE

- ISL-35-M-5
- ISL-35-OAK-5
- ISL-35-CH-5

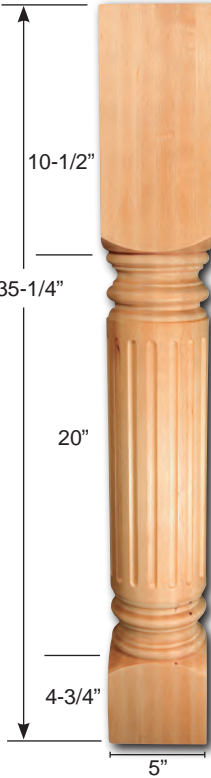

FLUTED

- ISL-40-M-5
- ISL-40-OAK-5
- ISL-40-CH-5
- ISL-40-HW-5

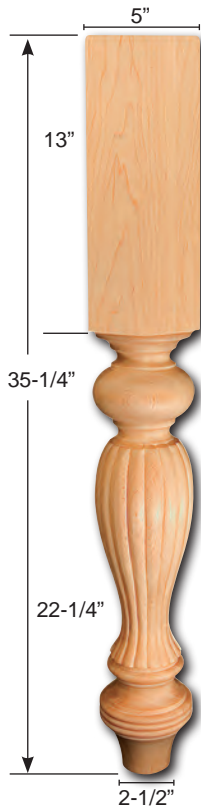

FRENCH

- ISL-45-M-5
- ISL-45-OAK-5
- ISL-45-CH-5



FULL ROUND

- ISL-50-M-5
- ISL-50-OAK-5
- ISL-50-CH-5
- ISL-50-HW-5



MISSION WEAVE

- ISL-80-M-5
- ISL-80-OAK-5
- ISL-80-CH-5

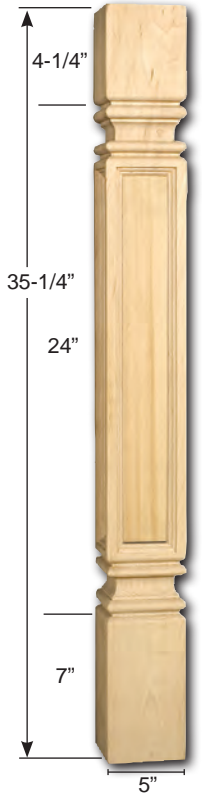

MISSION PLAIN

- ISL-85-M-5
- ISL-85-OAK-5
- ISL-85-CH-5
- ISL-85-HW-5

SOLID NORTH AMERICAN HARDWOOD

North American Hard Maple, Red Oak, Cherry or Hardwood (Paint Grade).

3-3/4" ISLAND LEGS

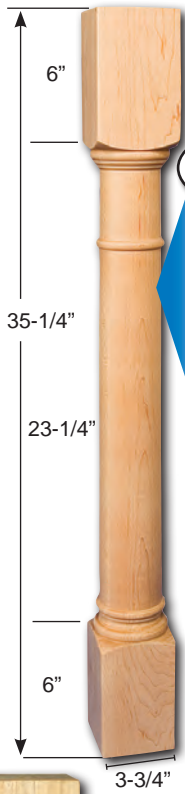

COLUMN

- ISL-75-M
- ISL-75-OAK
- ISL-75-CH
- ISL-75-HW



HERRINGBONE COLLECTION

- ISL-70-M
- ISL-70-OAK
- ISL-70-CH



MISSION WEAVE

- ISL-80-M
- ISL-80-OAK
- ISL-80-CH



OPEN WEAVE

- ISL-90-M
- ISL-90-OAK
- ISL-90-CH

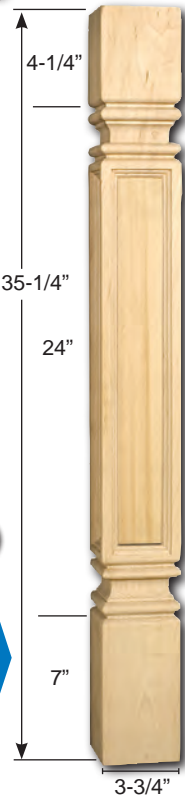

MISSION PLAIN

- ISL-85-M
- ISL-85-OAK
- ISL-85-CH
- ISL-85-HW

2-3/4" CORNER POSTS

All corner posts dimensions:
34-1/2" High, 2-3/4" Deep, 2-3/4" Wide.



- GRAPE**
- CCP-10-M
 - CCP-10-OAK
 - CCP-10-CH



- ACANTHUS LEAF**
- CCP-20-M
 - CCP-20-OAK
 - CCP-20-CH
 - CCP-20-HW



- WEAVE**
- CCP-30-M
 - CCP-30-OAK
 - CCP-30-CH



SOLID NORTH AMERICAN HARDWOOD



- North American Hard Maple, Red Oak, Cherry or Hardwood (Paint Grade).
- No Sanding - Ready To Finish.
- Stain or Paint.

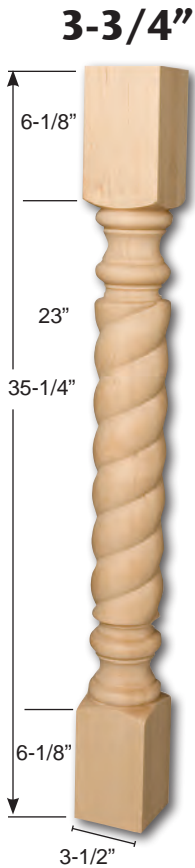

ROPE
(right twist only)
ISL-35-M
ISL-35-OAK
ISL-35-CH



FLUTED
ISL-40-M
ISL-40-OAK
ISL-40-CH
ISL-40-HW



FRENCH
ISL-45-M
ISL-45-OAK
ISL-45-CH

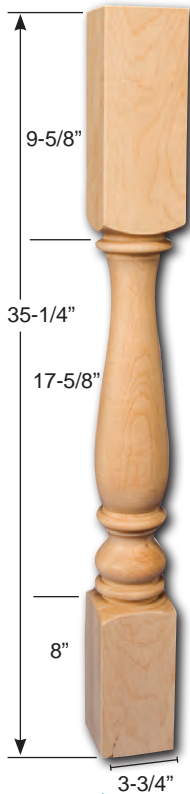

FULL ROUND
ISL-50-M
ISL-50-OAK
ISL-50-CH
ISL-50-HW



HALF ROUND
(flush mount)
1-3/4" PROJECTION
ISL-H-55-M
ISL-H-55-OAK
ISL-H-55-CH
ISL-H-55-HW



ACANTHUS LEAF
ISL-60-M
ISL-60-OAK
ISL-60-CH
ISL-60-HW



GRAPE
ISL-65-M
ISL-65-OAK
ISL-65-CH